



Vacuum generation | Multi-chamber ejectors

Multi-chamber ejectors, high suction power

Multi-chamber ejectors, high suction power

High suction power for fast vacuum build up with porous workpieces



Application example: Multi-chamber ejector with vacuum gauge 91.001 (mounting on front or rear side)

Product notes

- > High vacuum level at low feed pressures, and thus particularly efficient use of compressed air as well as suitability for fluctuating air pressure levels
- > Handling of porous products, or for high leakages
- > High suction power for short evacuation times in the lower vacuum range
- > Noise-optimized operation due to open silencer
- > Industry examples: packaging and printing

Ordering notes

- > Seals optionally available in NBR as standard
- > Optionally available in EPDM or Viton upon request
- > Included in scope of delivery: Two mounting brackets and G1/4"-male – Ø 10 mm quick fitting for compressed air connection

Technical data

Item no.	65.340	65.350	65.360	65.370	65.380	65.390
Optimal operating pressure [bar (psi)]	3.4 (49.3)	3.4 (49.3)	3.4 (49.3)	3.4 (49.3)	3.4 (49.3)	3.4 (49.3)
Max. operating pressure [bar (psi)]	7 (101.5)	7 (101.5)	7 (101.5)	7 (101.5)	7 (101.5)	7 (101.5)
Final vacuum at 3.4 bar (49.3 psi) [%]	92	92	92	92	92	92
Final vacuum at 6 bar (87 psi) [%]	89	89	89	89	89	89
Suction power at 3.4 bar (49.3 psi) [NI/min]	360	600	760	850	1,150	1,200
Suction power at 6 bar (87 psi) [NI/min]	420	700	950	1,010	1,400	1,500
Air consumption at 3.4 bar (49.3 psi) [NI/min]	116	230	365	445	545	655
Air consumption at 6 bar (87 psi) [NI/min]	185	370	610	720	780	810
Evacuation time 1 liter from 0 to 70 % at 3.4 bar (49.3 psi) [s]	0.95	0.5	0.46	0.27	0.2	0.23
Evacuation time 0 to 70 % at 6 bar (87 psi) [s]	0.62	0.35	0.31	0.19	0.19	0.2
Noise level with silencer [dB]	60 - 65	60 - 65	60 - 65	60 - 65	60 - 65	60 - 65
Usage temperature [°C (°F)]	-20 - 80 (-4 - 176)	-20 - 80 (-4 - 176)	-20 - 80 (-4 - 176)	-20 - 80 (-4 - 176)	-20 - 80 (-4 - 176)	-20 - 80 (-4 - 176)
Weight incl. silencer [g]	690	690	880	880	1,160	1,160
Suitable accessories	Vacuummeter: 91.001 Vacuum switch: GS02.001 Double nipple: 270.138 Double nipple: 270.148 Silencer: 72.032			Vacuummeter: 91.001 Vacuum switch: GS02.001 Double nipple: 270.138 Double nipple: 270.148 Silencer: 72.032		



Suction power [NI/min] at vacuum level (feed pressure 3.4 bar (49.3 psi))

Item no.	10 %	20 %	30 %	40 %	50 %	60 %	70 %	80 %	90 %
65.340	180	115	80	43	30	22.5	15.5	7.5	1.2
65.350	320	250	135	75	60	46	30	13	1.5
65.360	445	340	175	110	85	70	43	20	1.8
65.370	550	430	280	145	115	85	60	28	2.2
65.380	760	530	350	180	148	115	78	34.5	3.5
65.390	830	550	360	215	170	130	90	36	5

Suction power [NI/min] at vacuum level (feed pressure 6 bar (87 psi))

Item no.	10 %	20 %	30 %	40 %	50 %	60 %	70 %	80 %	90 %
65.340	240	125	100	82	65	38	12.5	3.5	--
65.350	510	290	195	160	115	70	22	8	--
65.360	710	380	285	230	170	100	32	11	--
65.370	800	460	385	310	215	125	42	15.5	--
65.380	1120	560	490	355	260	150	50	25	--
65.390	1110	630	560	385	315	210	65	26	--

Evacuation time [s/l] at vacuum level (operating pressure 3.4 bar(49.3 psi))

Item no.	10 %	20 %	30 %	40 %	50 %	60 %	70 %	80 %	90 %
65.340	0.022	0.06	0.11	0.21	0.4	0.65	0.95	1.6	4
65.350	0.014	0.031	0.06	0.1	0.2	0.34	0.5	0.8	2.5
65.360	0.012	0.029	0.058	0.095	0.18	0.31	0.46	0.89	1.5
65.370	0.01	0.025	0.043	0.075	0.11	0.19	0.27	0.45	1.2
65.380	0.006	0.015	0.029	0.052	0.085	0.145	0.202	0.33	1
65.390	0.005	0.013	0.027	0.045	0.07	0.105	0.23	0.46	0.9

Evacuation time [s/l] at vacuum level (operating pressure 6 bar (87 psi))

Item no.	10 %	20 %	30 %	40 %	50 %	60 %	70 %	80 %	90 %
65.340	0.018	0.05	0.08	0.18	0.25	0.4	0.62	1.55	--
65.350	0.01	0.022	0.048	0.08	0.11	0.2	0.35	0.78	--
65.360	0.009	0.019	0.045	0.075	0.13	0.18	0.31	0.7	--
65.370	0.007	0.018	0.038	0.055	0.08	0.12	0.19	0.47	--
65.380	0.005	0.013	0.026	0.045	0.062	0.115	0.194	0.56	--
65.390	0.003	0.009	0.014	0.030	0.060	0.095	0.2	0.8	--



Vacuum generation | Multi-chamber ejectors

Multi-chamber ejectors, high suction power

Recommended inner diameter [mm] for tubing up to length of 2 meter

Item no.	Air supply	Vacuum	Exhaust
65.340	> 4	> 12	> 12
65.350	> 6	> 15	> 15
65.360	> 8	> 19	> 22
65.370	> 8	> 19	> 22
65.380	> 10	> 25	> 32
65.390	> 10	> 25	> 32

Dimensions

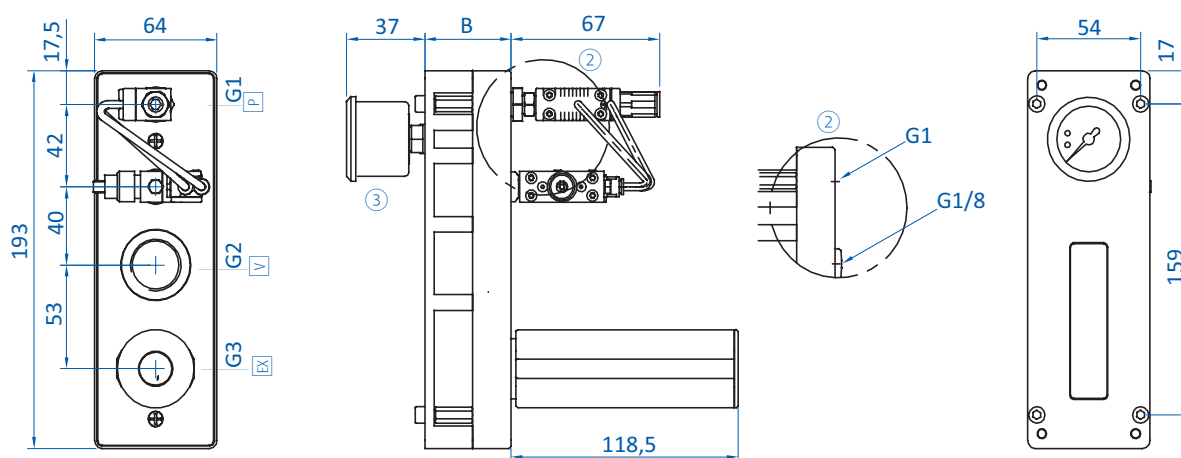

② = Connection vacuum gauge and/or vacuum switch ③ = Vacuum gauge (optional) P = Compressed air connection V = Vacuum connection
 R = Exhaust outlet (R)

Item no.	65.340	65.350	65.360	65.370	65.380	65.390
G1	G1/4	G1/4	G1/4	G1/4	G1/4	G1/4
G2	G3/4	G3/4	G3/4	G3/4	G1	G1
G3	G3/4	G3/4	G3/4	G3/4	G1	G1
B [mm]	45	45	65	65	85	85



Diagrams

> Air consumption against feed pressure

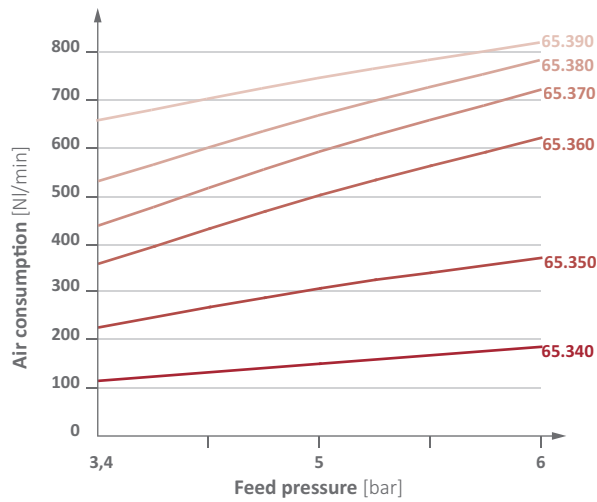

> Suction power against feed pressure

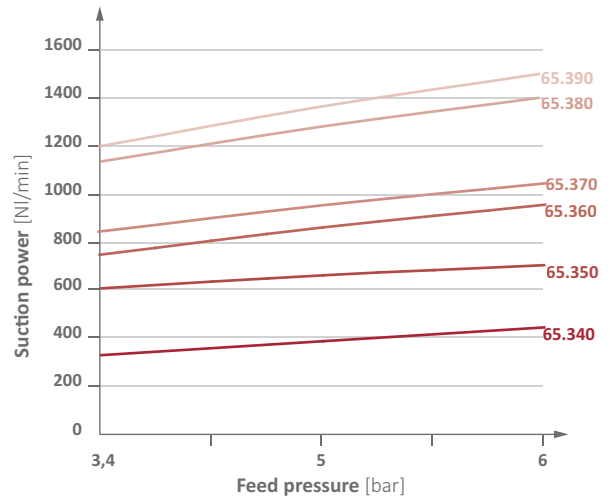

> Vacuum level against feed pressure

