



# Vacuum generation | Heavy-duty ejectors

## Heavy-duty ejectors

### Heavy-duty ejectors

Vacuum generation for use under harsh operating conditions



#### Product notes

- > Robust and compact aluminum housing
- > Compensation of compressed air fluctuations between 3 and 6 bar (43.5 and 87 psi)
- > Additional inlet for blow-off for fast product release or vacuum switch connection for process monitoring (65.111, 65.130)
- > Rectangular design enables block assembly in centralized or decentralized vacuum systems

#### Technical data

Item no.	Optimal operating pressure [bar (psi)]	Max. operating pressure [bar (psi)]	Final vacuum [%]	Suction power [Nl/min]	Air consumption to 4 bar (58 psi) [Nl/min]	Evacuation time 0 to 70% [s/l]	Weight [g]	Suitable accessories
65.102A	4 (58)	6 (87)	85	30	50	3.5	48	Silencer: 72.001 Silencer: 72.029
65.111	4 (58)	6 (87)	85	33	60	3	120	Silencer: 72.002 Silencer: 72.030
65.120	4 (58)	6 (87)	85	85	130	1.5	125	Silencer: 72.031
65.130	4 (58)	6 (87)	85	130	240	0.7	225	Silencer: 72.033

#### Dimensions

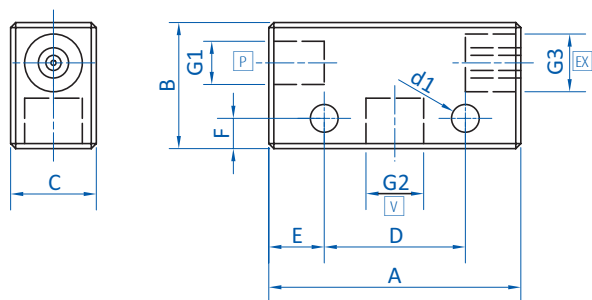

65.102A

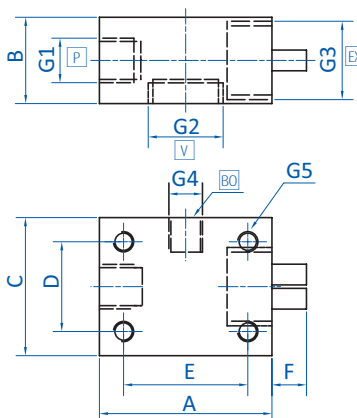

65.111 | 65.120 | 65.130

[P] = Compressed air connection (P) [V] = Vacuum connection [Ex] = Exhaust [BO] = Blow-off (65.111 and 65.130)

Item no.	G1	G2	G3	G4	G5	A [mm]	B [mm]	C [mm]	D [mm]	d1 [mm]	E [mm]	F [mm]
65.102A	G1/8	G1/4	G1/4	--	--	50	25	17	28	5.5	11	6
65.111	G1/4	G1/2	G3/8	G1/8	6.5	50	25	40	25	--	34	8
65.120	G1/4	G1/2	G1/2	--	M6	50	25	40	25	--	34	10
65.130	G1/4	G1/2	G1	G1/8	M6	60	40	40	25	--	34	--



### Diagrams

> Suction power against feed pressure

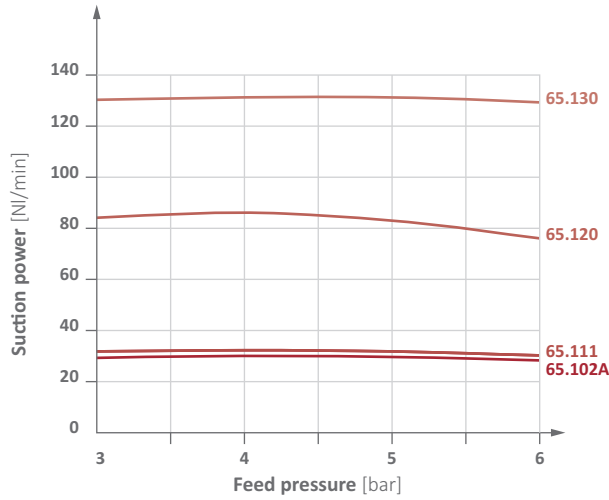

> Air consumption against feed pressure

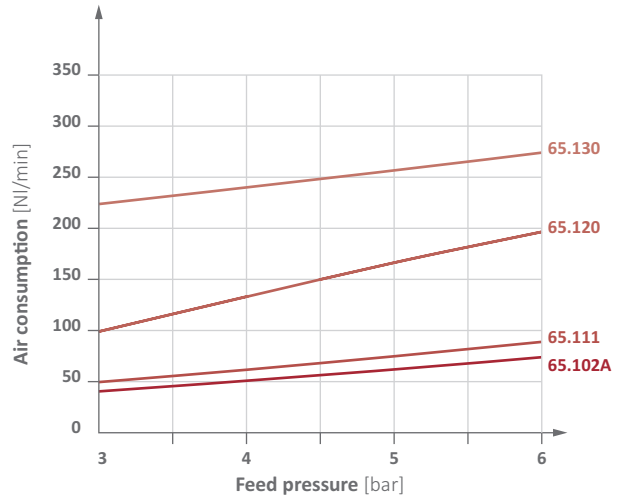

> Vacuum level against feed pressure

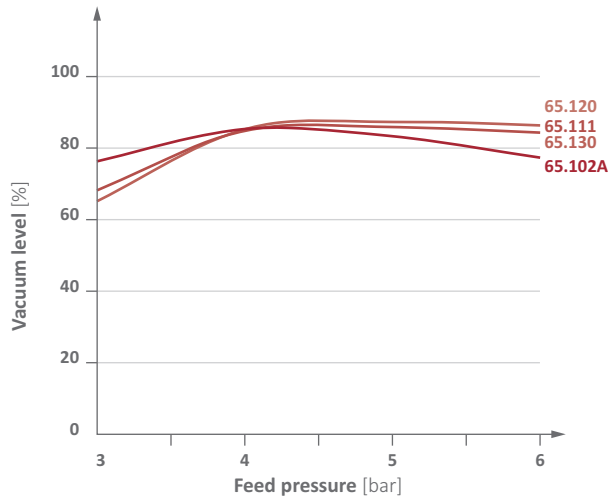

Suction power [Nl/min] at vacuum level

Item no.	10 %	20 %	30 %	40 %	50 %	60 %	70 %	80 %
65.102A	25	23	19	15	13	8	4	1
65.111	25	23	20	17	13	8	4	1
65.120	76	66	55	41	34	22	12	3
65.130	182	160	135	69	52	33	17	6