



Grippers | Sprue grippers

Series 110 – grippers

Series 110 – grippers



Product notes

- > High grip force, extra wide jaw opening and gap-free closing allow for a wide range of sprue diameters to be gripped
- > Principle of operation: double-acting

Technical data

Item no.	Max. operating pressure [bar (psi)]	Closing force at 6 bar (87 psi) [N]	Weight [g]	Suitable fittings
GR04.110	8 (116)	66	135	GR04.197A

Dimensions

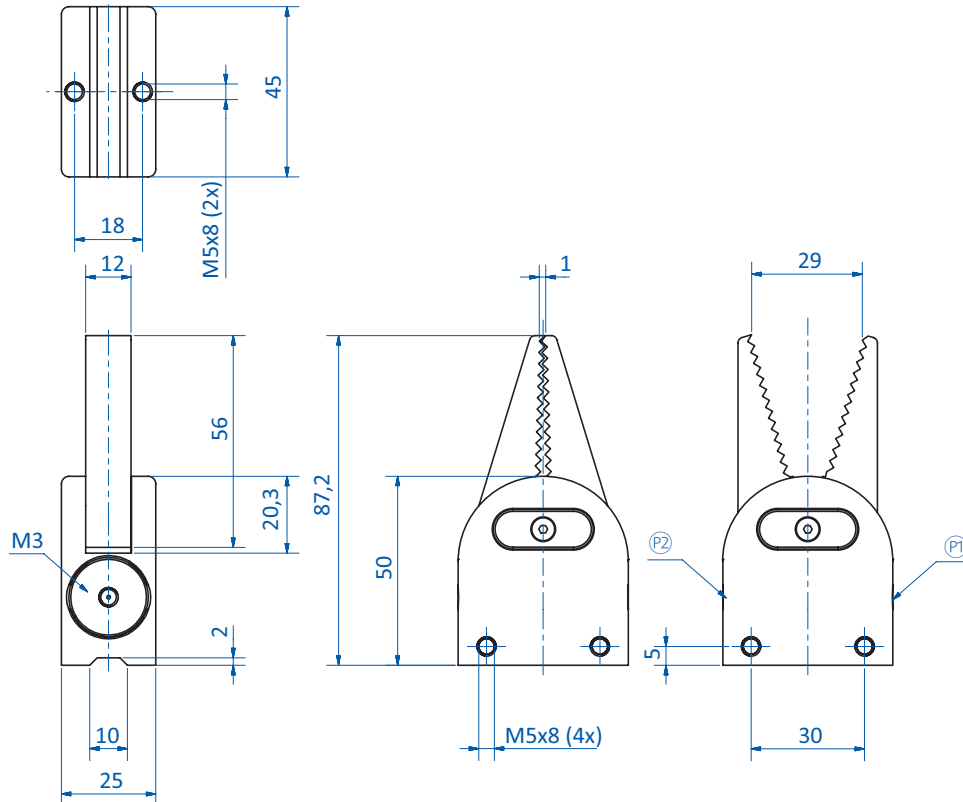

Ⓟ = Compressed air supply (open) Ⓠ = Compressed air supply (close)