



Series 120 – sprue grippers with indirect sensing



Product notes

- > GR04.120 for special gripper jaws
- > GR04.120LD and GR04.120DR for gates with \varnothing 10 - 25 mm
- > GR04.120DR with extra wide gripper jaws
- > Principle of operation: single-acting NO, can also be operated double-acting

Technical data

Item no.	Jaw	Operating pressure [bar (psi)]	Sensor	Closing force at 6 bar (87 psi) [N]	Max. sprue diameter [mm]	Weight [g]	Spare pair of jaws
GR04.120	Universal	8 (116)	Optional	--	--	141	--
GR04.120LD	Standard	8 (116)	Optional	83	25	202	GR04.120LD-KIT
GR04.120DR	Xwide	8 (116)	Optional	83	25	206	GR04.120LD-KIT

Accessories

Mounting bracket	Clamping diam. 14 mm, shaft length 50 mm	GR04.196A
Sensors	2 switching points teachable, 500 mm cable, 4-pin male M8 connector	PNP GS04.005
		NPN GS04.006
	Standard, 300 mm cable, 3-pin male M8 connector	PNP GR04.198
		NPN GR04.198/NPN
Connecting cables	4-pin female M8 straight, unterminated cable, 5 m long	20.501
	3-pin female M8 straight, unterminated cable, 2 m long	20.503
	3-pin female M8 90°, unterminated cable, 2 m long	20.507
Extension cables	3-pin female M8, 3-pin male M8, 0.3 m long	20.504
	3-pin female M8, 3-pin male M8, 1.5 m long	20.570
Adapter	4-pin female M8 to 3-pin male M8 (one signal is lost)	M8B4 / M8S3
Connectors	3-pin male M8	20.528



Grippers | Sprue grippers

Series 120 – sprue grippers with indirect sensing

Dimensions

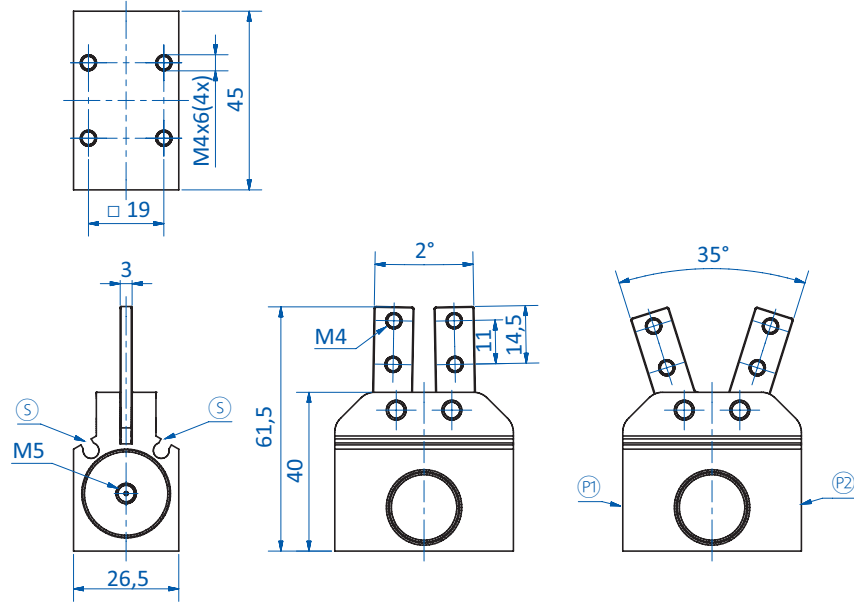

GR04.120

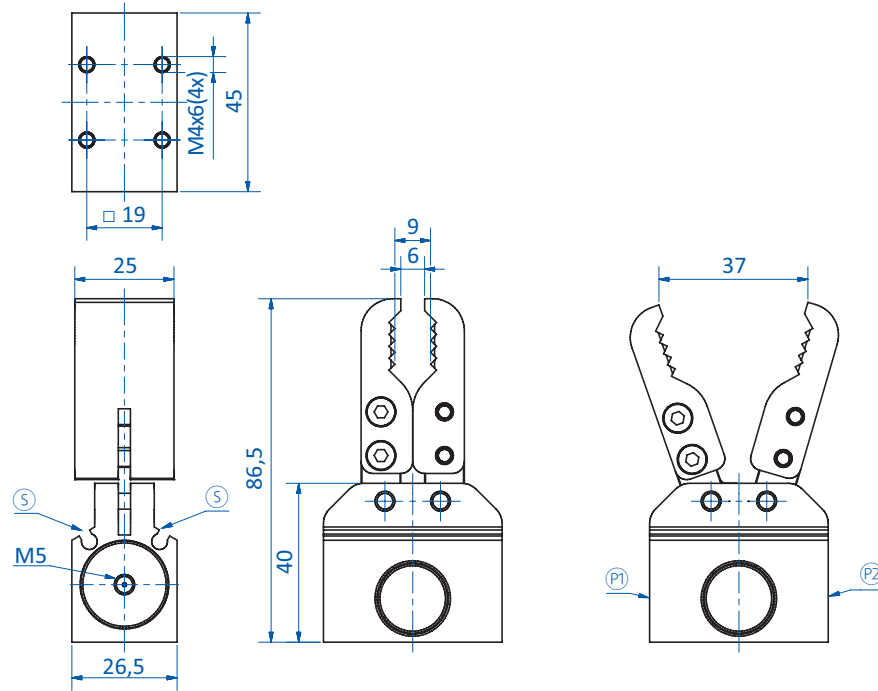

GR04.120LD

P1 = Compressed air supply (open) P2 = Compressed air supply (close) S = Sensor slot



Dimensions

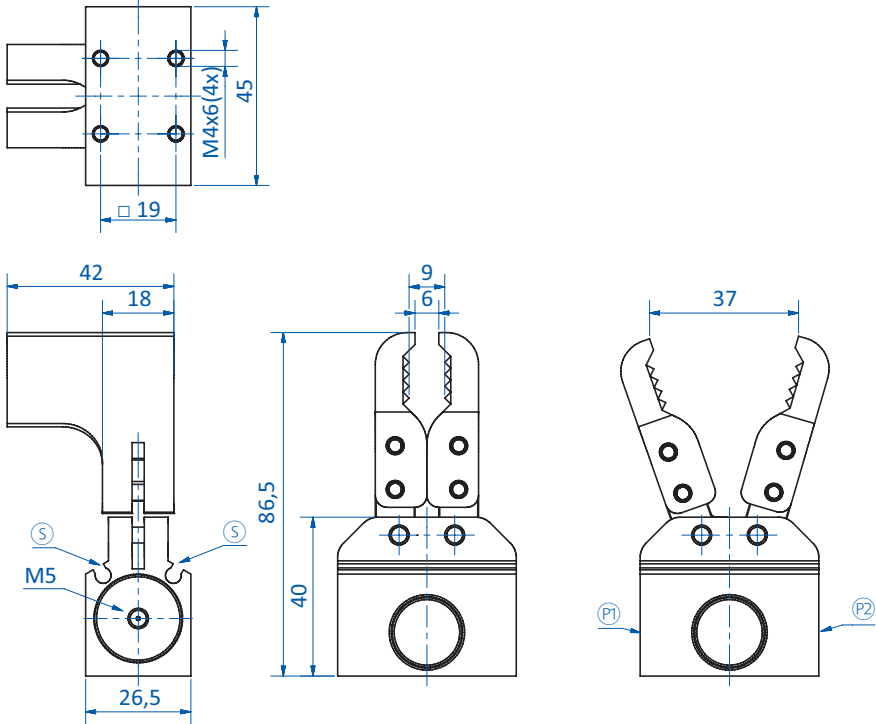

GR04.120DR

P1 = Compressed air supply (open) P2 = Compressed air supply (close) S = Sensor slot