



Non-return valves for very high volume flows



Product notes

- > Maintenance of the vacuum level in suction systems in cases of vacuum generator failure
- > Suitable for installation between the vacuum pump and vacuum tank
- > Prevents return flow of the oil into the vacuum system with vacuum pumps without an integrated non-return valve
- > Can be mounted in any installation position

Technical data

Item no.	Nominal flow rate [m ³ /h]	Material	Weight [g]
32.647	20	Brass with oil-resistant seals	151
32.648	26	Brass with oil-resistant seals	196
32.649	45	Brass with oil-resistant seals	280
32.650	75	Brass with oil-resistant seals	421
32.651	125	Brass with oil-resistant seals	658
32.652	200	Brass with oil-resistant seals	897
32.653	350	Brass with oil-resistant seals	1,346

Dimensions

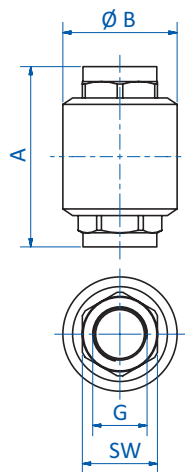

Item no.	G	A [mm]	Ø B [mm]	SW
32.647	G3/8	55	35	23
32.648	G1/2	58	58.5	27
32.649	G3/4	65	41	33
32.650	G1	74.5	48	40
32.651	G1 1/4	83	60.5	50
32.652	G1 1/2	93	71	55
32.653	G2	101	87	70