



Vacuum regulators



Vacuum regulator 33.105 with vacuum gauge

Product notes

- > Vacuum adjustment of consumer loads, such as vacuum cups in handling systems
- > Integration of a vacuum gauge recommended
- > Blow-off is possible if vacuum gauge is not connected
- > Any installation position
- > Vacuum gauge not included in scope of delivery

Technical data

Item no.	Max. flow rate [m ³ /h]	Regulating range [mbar (psi)]	Operating temperature [°C (°F)]	Weight [kg]	Suitable vacuum gauge
33.105	10	-200 - -999 (-2.9 - -14.5)	-10 - 80 (14 - 176)	0.6	91.001
33.120	80	-200 - -999 (-2.9 - -14.5)	-10 - 80 (14 - 176)	2.1	91.003

Dimensions

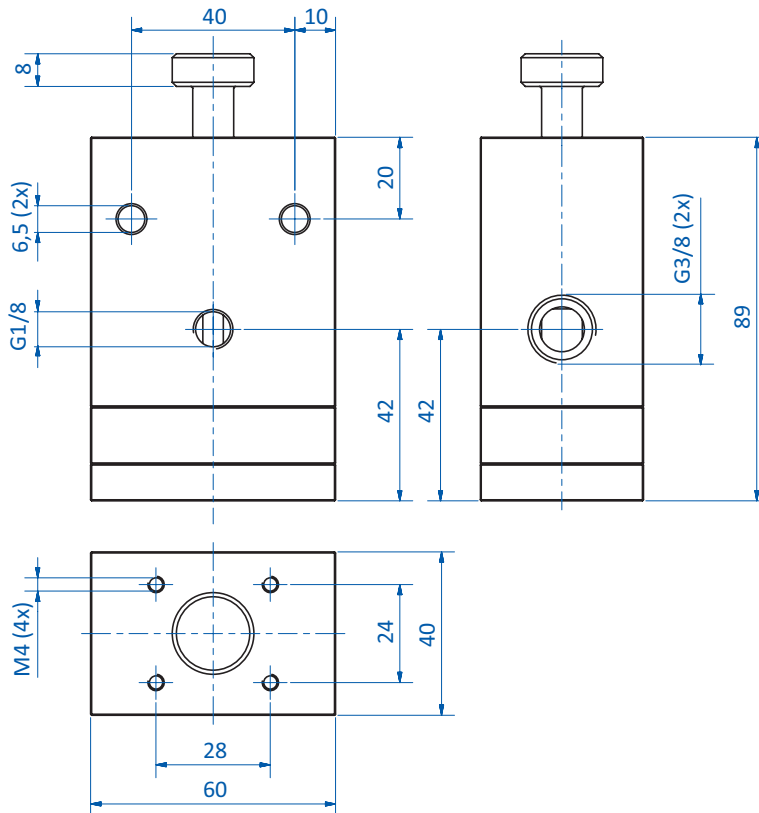

33.105



Dimensions

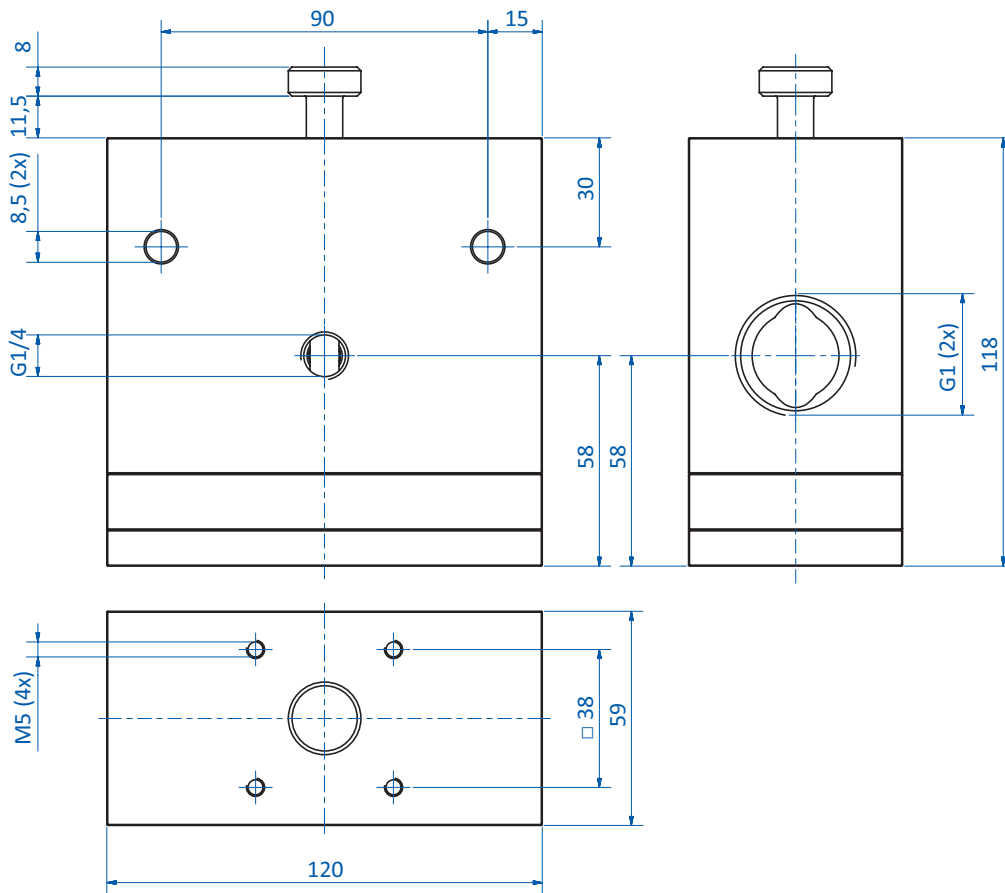

33.120