



## Series | Flat vacuum cups SF

Flat vacuum cups with long shaft – SFU-L

### Flat vacuum cups with long shaft – SFU-L



#### Product description

Flat vacuum cups for handling sensitive or uneven and slightly curved products. Long, slim design enables pipe mounting and low gimbal leveling for uneven product surfaces.

#### Advantage

- > Gentle handling of particularly sensitive products
- > Cost-effective replacement of worn seals

#### Technical data

Item no.	Model / Lip dimensions		Material / Colour
122.006.002.*	SFU-L-6	1.5	NBR (sw), SI (tr)
122.010.005.*	SFU-L-10	1.5	NBR (sw), SI (tr), SI-LE (tr)
122.016.009.*	SFU-L-16	5	NBR (sw), SI (tr), NR (sw)
122.025.025.*	SFU-L-25	5	NBR (sw), SI (tr), NR (sw)
122.040.043.*	SFU-L-40	4	SI (tr), NR (sw)
122.060.059.*	SFU-L-60	10	NBR (sw), SI (tr), NR (sw)

#### Accessories

Item no.	 Suitable fittings				
	M5-male	G1/8-male	G1/8-female	G1/4-male	G1/4-female
122.006.002.*	270.001	--	--	--	--
122.010.005.*	270.022	--	--	--	--
122.016.009.*	270.013	270.003	270.015	270.194	--
122.025.025.*	--	270.132	270.114	270.043	270.178
122.040.043.*	--	--	--	270.049-1	--
122.060.059.*	--	--	--	270.049-1	--

\* When ordering please add the appropriate material code to item no. You will find it on [www.fipa.com](http://www.fipa.com).



### Dimensions

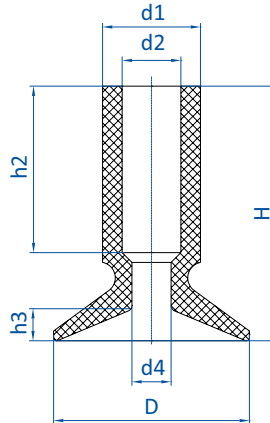

Item no.	∅ D [mm]	∅ d1 [mm]	∅ d2 [mm]	∅ d4 [mm]	H [mm]	h2 [mm]	h3 [mm]
122.006.002.*	6	4	2	1	12	8	1.3
122.010.005.*	10	5	3	2	13	8.5	1.6
122.016.009.*	16	8	4.8	2.5	20	13	3.8
122.025.025.*	25	12	8	4	30	18	5.5
122.040.043.*	43	20	11	4.4	41	22	10.2
122.060.059.*	62	24	11	6	45	21	14.5

\* When ordering please add the appropriate material code to item no. You will find it on [www.fipa.com](http://www.fipa.com).