

Vacuum glass lifter

GLAXTER – GL-10

1200kg



Vacuum lifter for construction site with manual tilt and rotation

Technical specification

Application	Glass panels
Lifting capacity	max 1200 kg
Suction pads	Nr. 10 round suction pads, diameter 390mm Lipped pads with safety ring
Pads spread	Pads movable in different positions Extension min mm 1240x915 – max 3050x1200
Load movement	Continuous 360 degree rotation, with possibility of automatic locking at each 90° 90 degree tilt, with possibility of automatic locking in upright and flat position
Operating system	DC vacuum pump powered from on-board batteries high capacity re-chargeable batteries battery status indicator economizer for reduction of the energy consumption
Vacuum system	2 independent vacuum circuits, each with vacuum reserve and non return valve
Weight of lifter	Kg 180
Structural depth	mm 250
Control	Manual on off valve on the lifter's frame Release of the load by dual action security command Remote control as optional
Standard features	Audible and visual low vacuum warning devices Vacuum gauge for each vacuum circuit Battery charger 240 Volt Vacuum filter Multi position hook connection Lowered suspension for installing of transom window

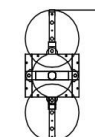
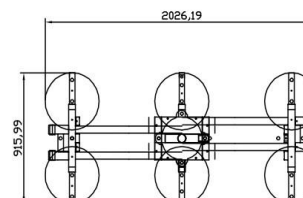
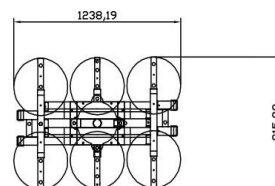
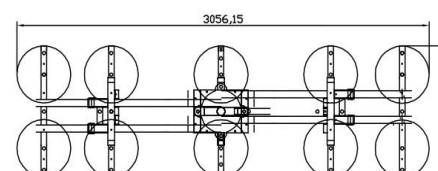
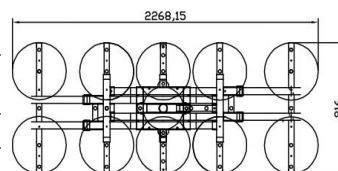
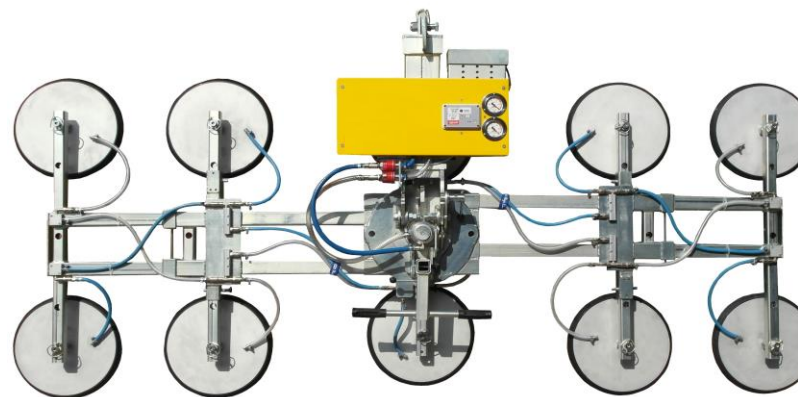

• Battery operating system

- 10 suction pads Ø 390 mm

- Manual continues 360° rotation
- Manual tilt 0-90°

- Lifting capacity 1200 kg

- Low vacuum warning device

- Suction pads and arms can be easily removed and replaced, allowing different configurations

- ✓ Dual vacuum circuit built to EN13155 standard

