

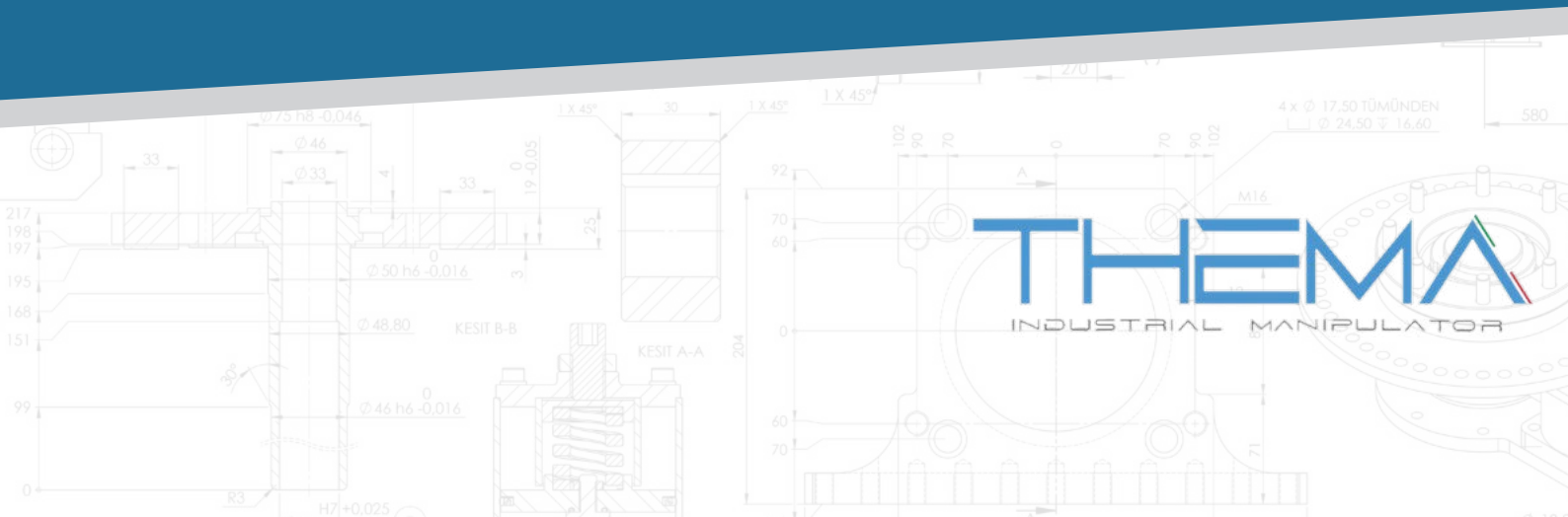

*Ergonomic,
safe and effective
handling.*

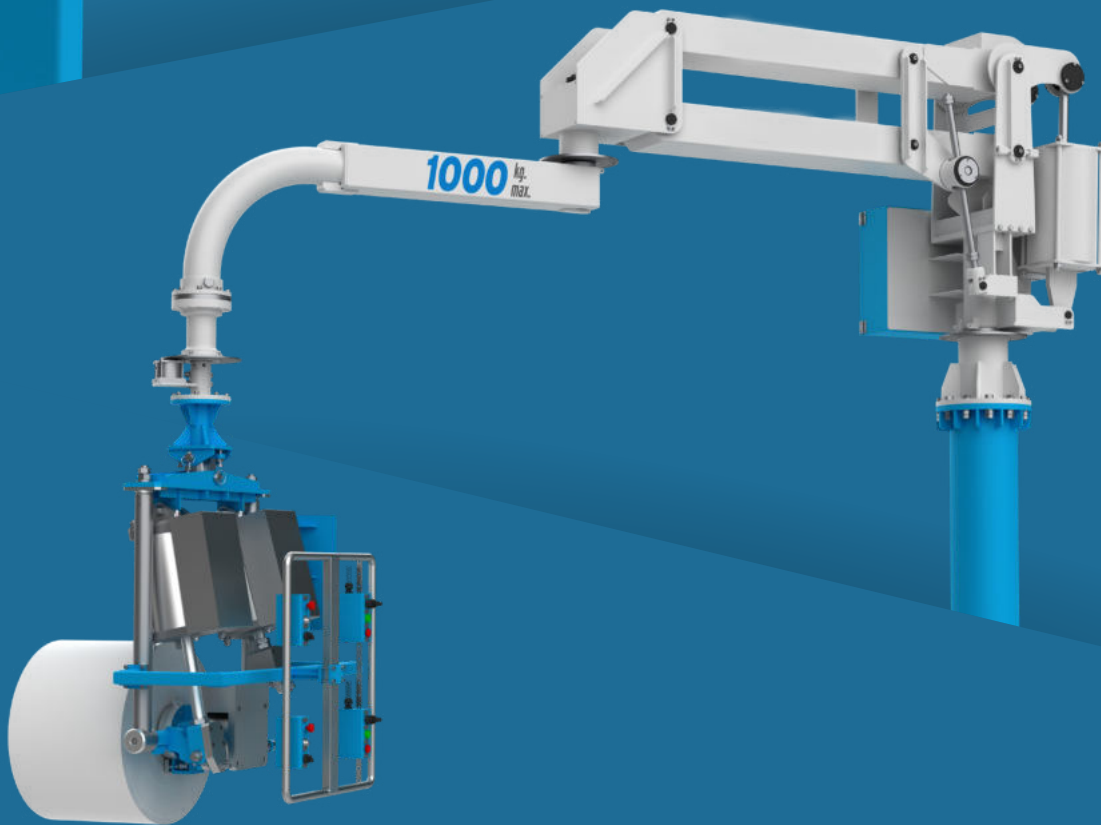

Thema

we design, weld, machine, paint, assemble
and quality check our products, all in one place!



60 kg.
max.

About Us

Thema was founded in 2018 in Italy . Even if Thema gives the impression of a young company, a closer look reveals that it is a company where experience, competence and know-how meet.

The founders of Thema have built a solid reputation for providing reliable, high-quality solutions to industry. With this know-how and this competence, Thema strives to become a subcontractor for other European companies.

Thema specializes in the areas of welded construction, mechanical engineering, casting and assembly. Quality optimization as well as quality and cost-optimized solutions are daily routine for us.

Thanks to the ISO 9001 and ISO 3834 certifications available for our manufacturers, we can guarantee consistently high quality. We create all our designs and simulations with Solidworks Premium Office.

Our products are produced according to the following European Standards:

MACHINES DIRECTIVE 2006/42/CE,
DIN EN 14238:2004+A1:2009,
DIN EN ISO 12100:2010 and DIN EN ISO 4414:2010.

Our own product, the pneumatic manipulators Thema Manipulators, is of course also produced according to the standards mentioned and is equipped with the CE mark.

Why Thema manipulators?

Thema manipulators are the answer to the need to handle loads of different types. We help in all possible areas, from warehouse logistics through various production areas to packaging industry.

Thema manipulators allow the ergonomic, safe and effective handling of almost all products. You can lift products up to 1,850 kg using only compressed air.

Due to the perfect load distribution, our manipulators enable almost weightless gripping and handling in all directions. The operator works effectively in maximum safety and ergonomic conditions.



THEMA Perseo

Pneumatic Manipulators with Double Rope System



Perseo Pneumatic Manipulators are designed to move operator-centered loads within the work area with minimum effort. It balances the weight of the load, allowing the operator to carry the load quickly and safely.

The balance of the load to be carried is provided by connecting two steel cables to the balance unit. Manipulators, either floor mounted or ceiling mounted. Manipulators are produced with standard hooks, but they can also be produced with special holders designed according to needs. The manipulator, which consists of two arms, has a total of two brakes on the arm rotation axis.

Works with dry, filtrated (40 μm) and oil free compressed air (min. 0.7/0.8 MPa).

60 kg max. weight capacity. 3.000 mm max. radius. 1.600 mm vertical lift.

21 nl/min max. air consumption.

Mounting Options

Perseo Column Mounted



Perseo Overhead Mounted



Perseo Overhead Trolley Mounted

Weight Capacity / kg

		60	35
Max. Radius / mm	Rmax	2500	3000
Min. Radius / mm	Rmin	190	200
Vertical Lift / mm	H	1600	1600
Min. Vertical Lift / mm	*h	200	200
Max. Height / mm	*Hmax	2525	2525
Max. Ceiling Height / mm	*Hf	2505	2505
Min. Height / mm	*Hmin	2000	2000

* Marked dimensions can change according to the customer request.

Mounting Plate Dimensions (mm)

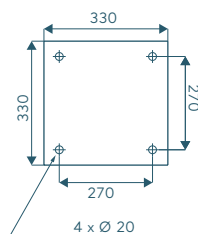
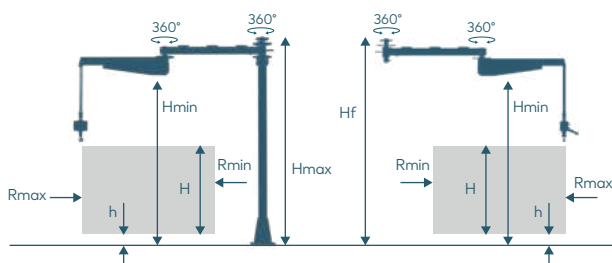

THEMA
INDUSTRIAL MANIPULATOR

THEMA Perseo Pro

Pneumatic Manipulators with Double Rope System



Perseo Pro Pneumatic Manipulators are designed to move operator-centered loads within the work area with minimum effort. It balances the weight of the load, allowing the operator to carry the load quickly and safely.

The balance of the load to be carried is provided by connecting two steel cables to the balance unit. Manipulators, either floor mounted or ceiling mounted. Manipulators are produced with standard hooks, but they can also be produced with special holders designed according to needs. The manipulator, which consists of two arms, has a total of two brakes on the arm rotation axis.

Works with dry, filtrated (40 μ m) and oil free compressed air (min. 0.7/0.8 MPa).

120 kg max. weight capacity. 4.500 mm max. radius. 1.800 mm vertical lift.
50 nl/min max. air consumption.

Mounting Options

Perseo Pro Column Mounted

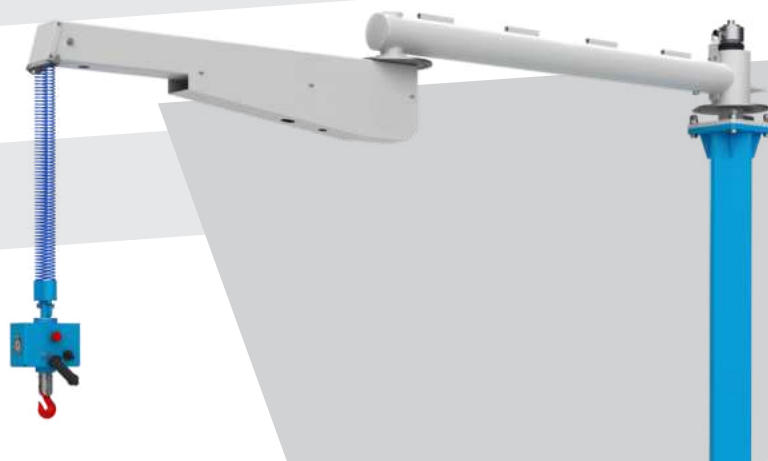

Perseo Pro Overhead Mounted

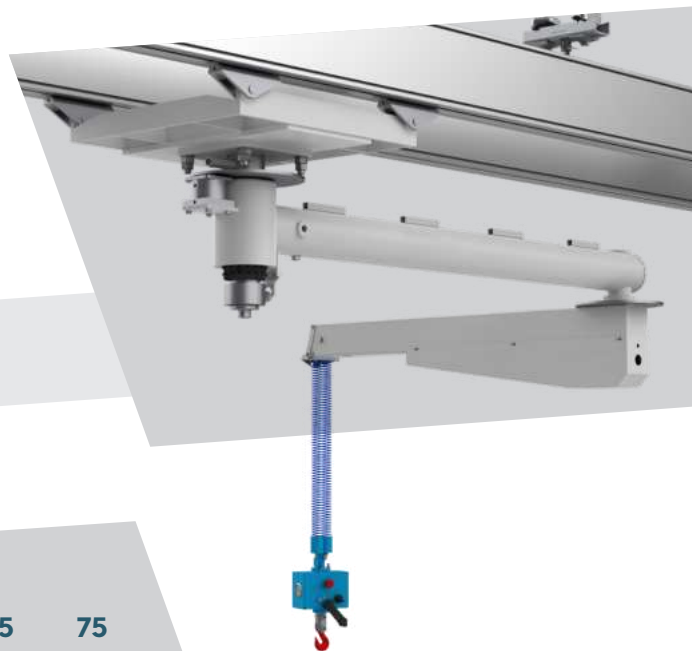

Perseo Pro Overhead Trolley Mounted

Weight Capacity / kg

		120	100	85	75
Max. Radius / mm	Rmax	3000	3500	4000	4500
Min. Radius / mm	Rmin	420	530	640	750
Vertical Lift / mm	H	1800	1800	1800	1800
Min. Vertical Lift / mm	*h	200	200	200	200
Max. Height / mm	*Hmax	2635	2635	2635	2635
Max. Ceiling Height / mm	*Hf	2550	2550	2550	2550
Min. Height / mm	*Hmin	2000	2000	2000	2000

* Marked dimensions can change according to the customer request.

Mounting Plate Dimensions (mm)

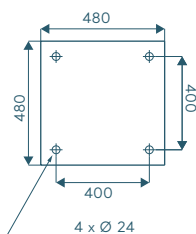
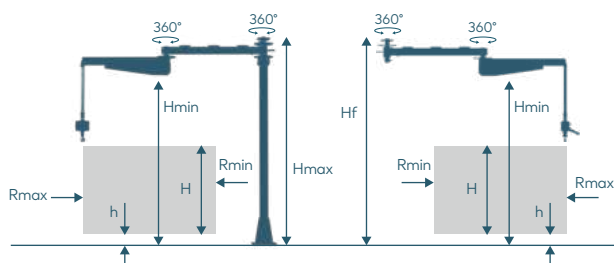

THEMA
INDUSTRIAL MANIPULATOR

Thema Narciso

Pneumatic Manipulators with Double Rope System



THEMA
INDUSTRIAL MANIPULATOR

*Narciso Pneumatic Manipulator, 300
kg carrying capacity version,
displayed with a clamp fixture.*

Narciso Pneumatic Manipulators are designed to move operator-centered loads within the work area with minimum effort. It balances the weight of the load, allowing the operator to carry the load quickly and safely.

The balance of the load to be carried is provided by connecting two steel cables to the balance unit. Manipulators, either floor mounted or ceiling mounted. Manipulators are produced with standard hooks, but they can also be produced with special holders designed according to needs. The manipulator, which consists of two arms, has a total of two brakes on the arm rotation axis.

Works with dry, filtrated (40 μ m) and oil free compressed air (min. 0.7/0.8 MPa).

300 kg max. weight capacity. 4.500 mm max. radius. 2.000 mm vertical lift.
140 nl/min max. air consumption.

Mounting Options

Narciso Column Mounted

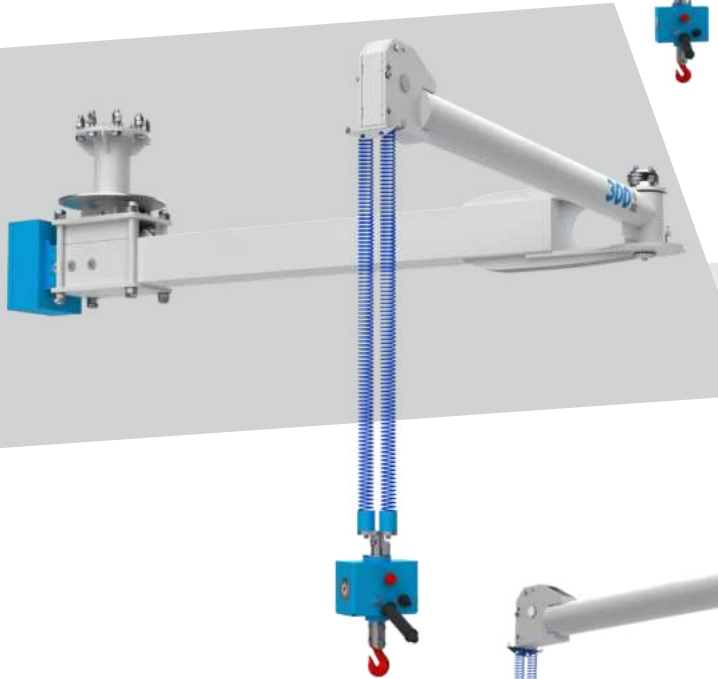

Narciso Overhead Mounted

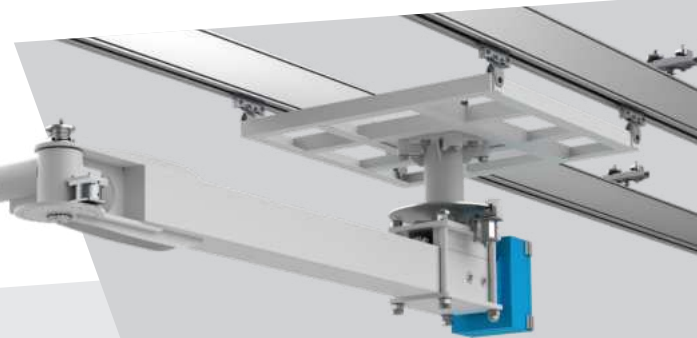

Narciso Overhead Trolley Mounted



Weight Capacity / kg

		200	Narciso 200				Narciso 300			
Max. Radius / mm	Rmax	3000	200	200	200	200	300	300	275	250
Min. Radius / mm	Rmin	650	3500	4000	4500	3000	650	760	870	980
Vertical Lift / mm	H	2000	2000	2000	2000	2000	2000	2000	2000	2000
Min. Vertical Lift / mm	*h	200	200	200	200	200	200	200	200	200
Max. Height / mm	*Hmax	2900	2900	2900	2900	2900	2900	2900	2900	2900
Max. Ceiling Height / mm	*Hf	3300	3300	3300	3300	3300	3300	3300	3300	3300
Min. Height / mm	*Hmin	2550	2550	2550	2550	2550	2550	2550	2550	2550

* Marked dimensions can change according to the customer request.

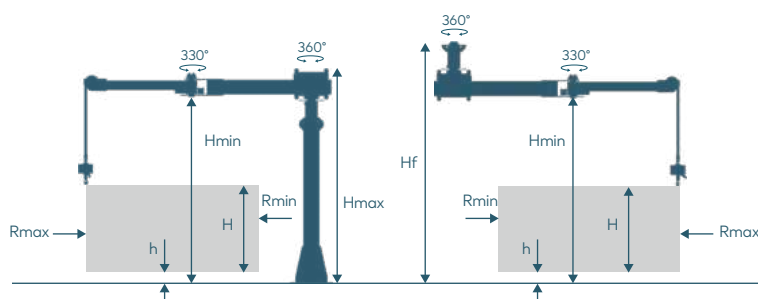

Mounting Plate Dimensions (mm)

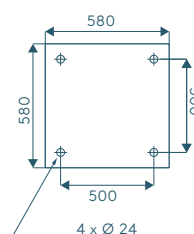

THEMA
INDUSTRIAL MANIPULATOR

THEMA Slite

Pneumatic Manipulators with Double Rope System

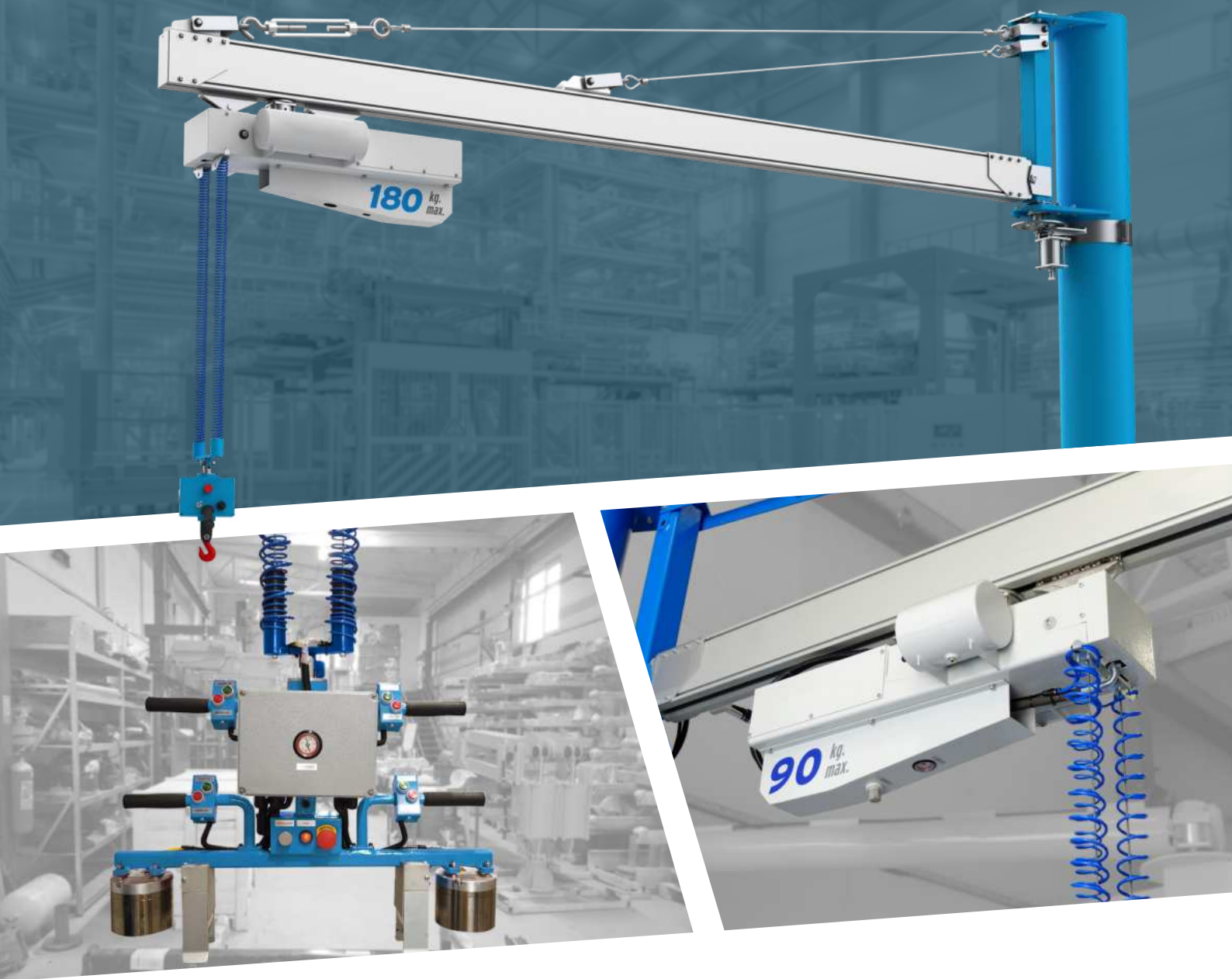

Slite Pneumatic Manipulators are designed to move operator-centered loads within the work area with minimum effort. It balances the weight of the load, allowing the operator to carry the load quickly and safely.

The balance of the load to be carried is provided by connecting two steel cables to the balance unit. Manipulators, either floor mounted or ceiling mounted. Manipulators are produced with standard hooks, but they can also be produced with special holders designed according to needs. The manipulator moves under aluminium rails which makes it easy to handle and gives precision throughout the working area.

Works with dry, filtrated (40 µm) and oil free compressed air (min. 0.7/0.8 MPa).

180 kg max. weight capacity. 6.000 mm max. radius. 1.600 mm vertical lift.
68 nl/min max. air consumption.

Mounting Options

Slite Jib Arm

Max. Radius / mm	Rmax	90 / 180
Min. Radius / mm	Rmin	4000 / 6000
Vertical Lift / mm	H	1350
Min. Vertical Lift / mm	*h	1600
Max. Height / mm	*Hmax	200
Min. Height / mm	*Hmin	3870
		2600

* Marked dimensions can change according to the customer request.

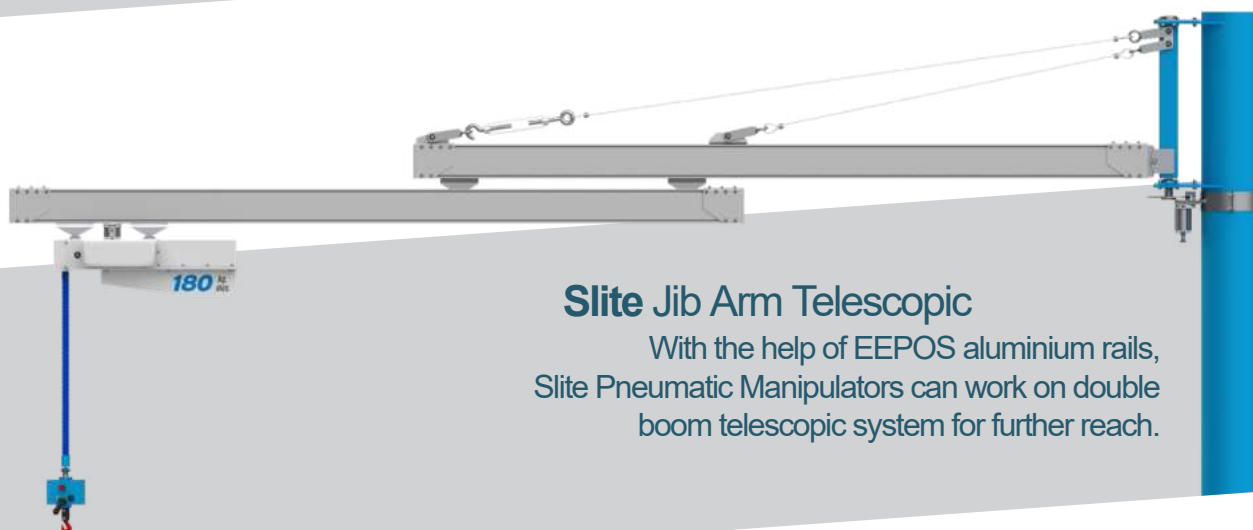
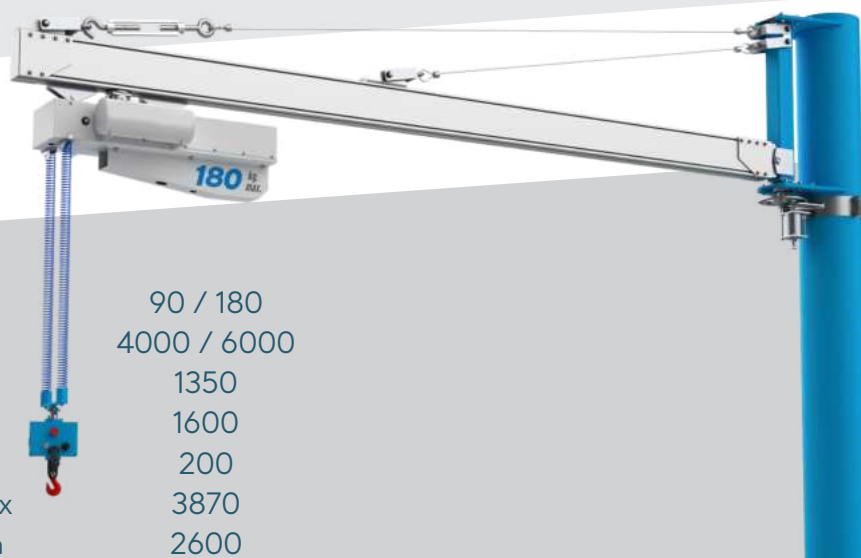

Slite Jib Arm Telescopic

With the help of EEPOS aluminium rails, Slite Pneumatic Manipulators can work on double boom telescopic system for further reach.

Slite Rail System

With our partnership with EEPOS Cranes, we can deliver special designs for your special needs.

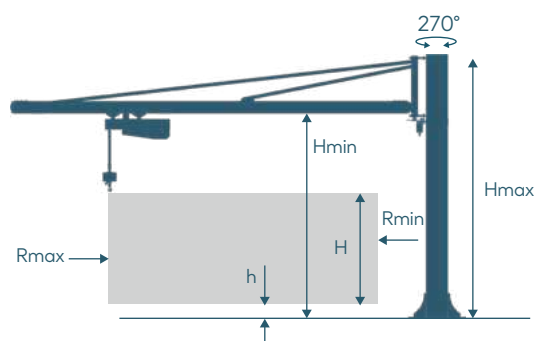
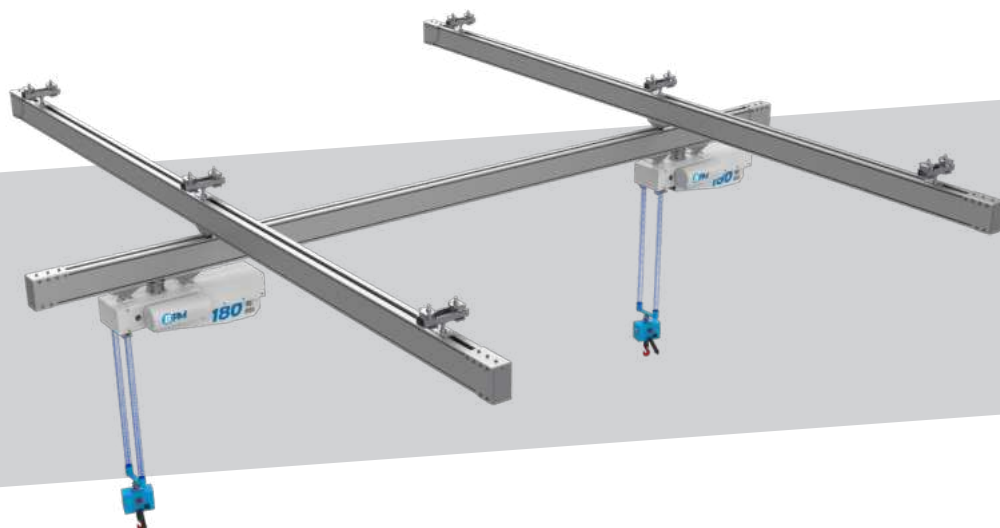

Mounting Plate Dimensions (mm)

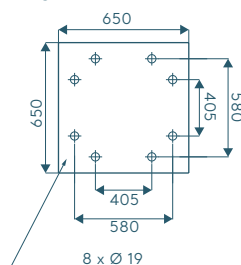

THEMA
INDUSTRIAL MANIPULATOR

THEMA Pegasus

Pneumatic Manipulators with Rigid Arms



*Pegasus Pneumatic Manipulator,
375 kg carrying capacity version, displayed with
the vacuum operated fixture designed to carry
glass panels.*

Pegasus Pneumatic Manipulators are designed to move operator-centered loads within the work area with minimum effort. It balances the weight of the load, allowing the operator to carry the load quickly and safely.

Manipulators, either floor mounted or ceiling mounted. Pegasus is equipped with special gripping tools which are particularly suitable to manually handle center offset loads in any direction, in a weightless condition. The manipulator, which consists of two arms, has a total of two brakes on the arm rotation axis. Its versatile structure allows it to fit in any working environment.

Works with dry, filtrated (40 µm) and oil free compressed air (min. 0.7/0.8 MPa).

375 kg max. weight capacity. 4.000 mm max. radius. 2.450 mm vertical lift.
140 nl/min max. air consumption.

Mounting Options

Pegasus Column Mounted

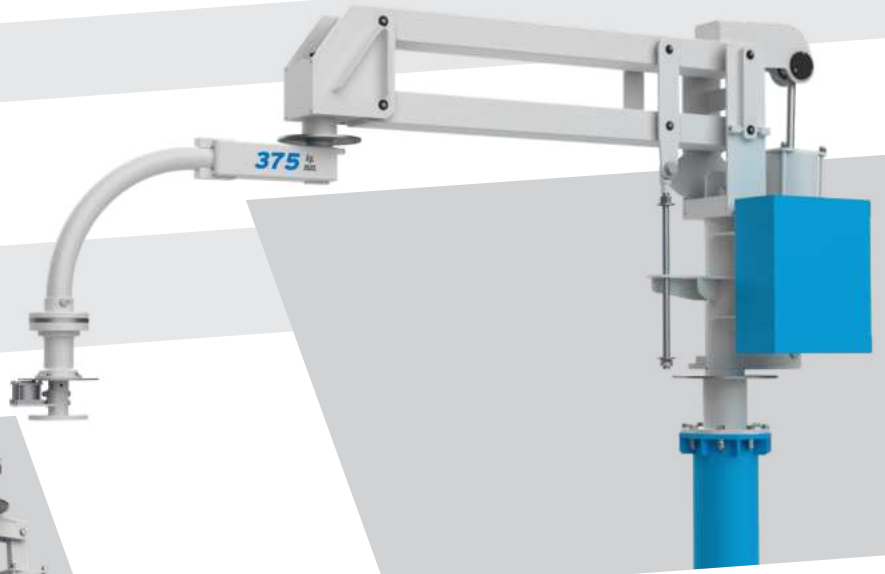

Pegasus Overhead Mounted

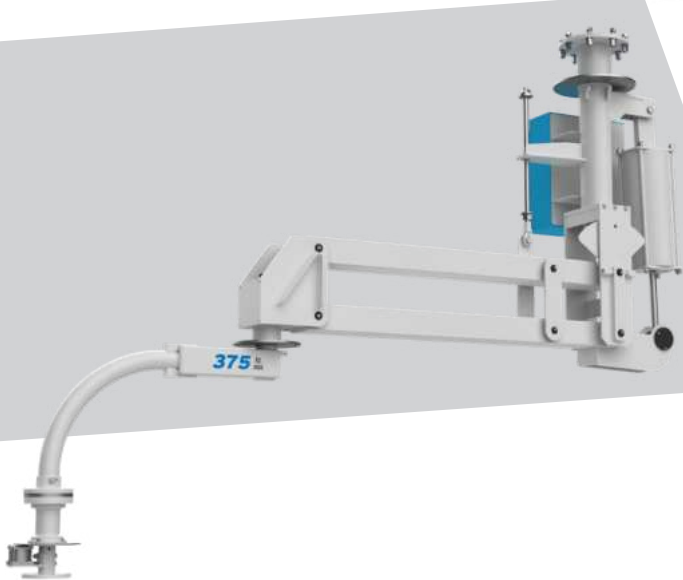

Pegasus Overhead Trolley Mounted



Pegasus Technical Details

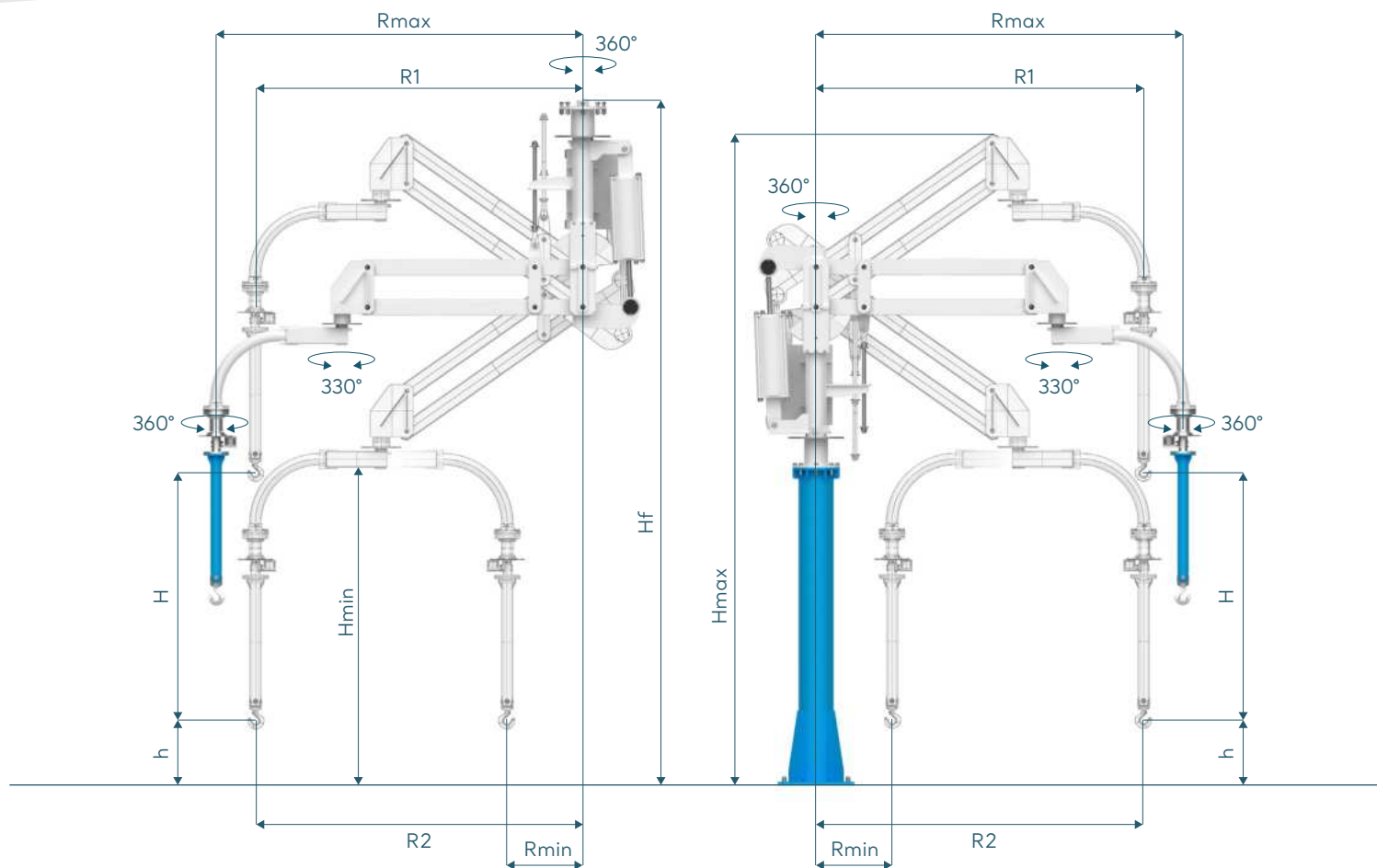

Weight Capacity / kg		375	250	175	110	60
Max. Radius / mm	Rmax	2000	2500	3000	3500	4000
Min. Radius / mm	Rmin	580	755	850	1000	1150
Vertical Lift / mm	H	1300	1700	2000	2400	2450
Min. Vertical Lift / mm	*h	200	200	200	200	200
Max. Height / mm	*Hmax	3860	4070	4225	4420	4610
Max. Ceiling Height / mm	*Hf	4100	4100	4800	5000	5000
Min. Height / mm	*Hmin	2000	2000	2000	2000	2000
Radius 1	R1	1750	2170	2610	3035	3465
Radius 2	R2	1750	2170	2610	3035	3465

* Marked dimensions can change according to the customer request.

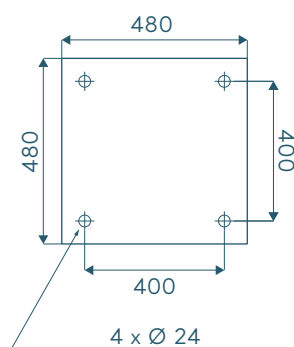

Mounting Plate Dimensions (mm)

Custom Design Fixtures

With Thema Manipulators, whatever load you carry, we develop a load-specific fixture design. Ergonomic, robust and for safe transport, we produce special fixtures with vacuum, pneumatic or magnetic catchers. They will carry any load with ease and comfort.

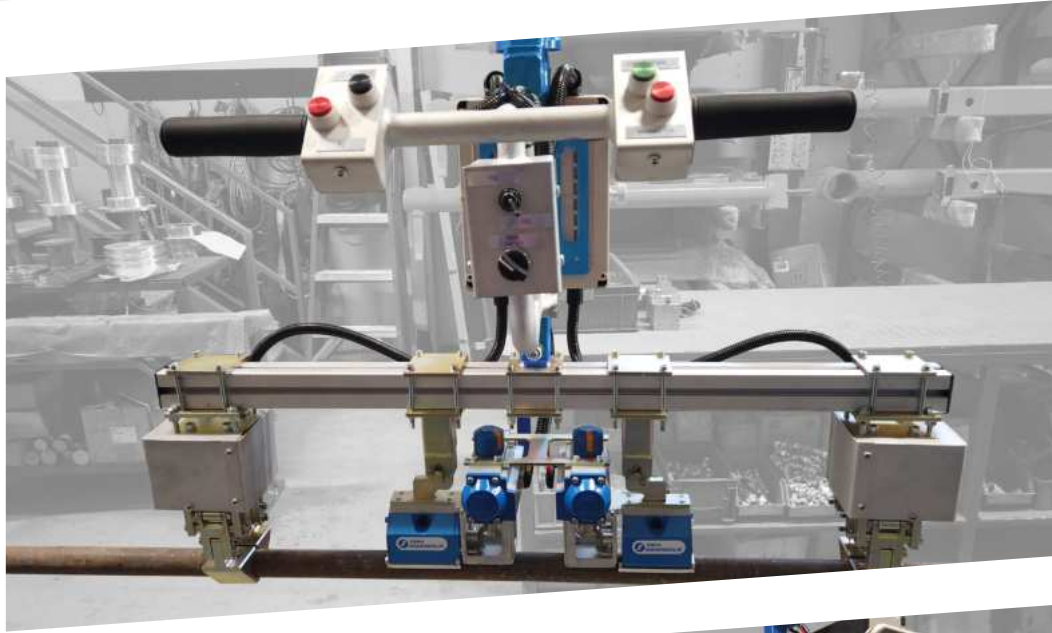

THEMA Pegasus Pro

Pneumatic Manipulators with Rigid Arms

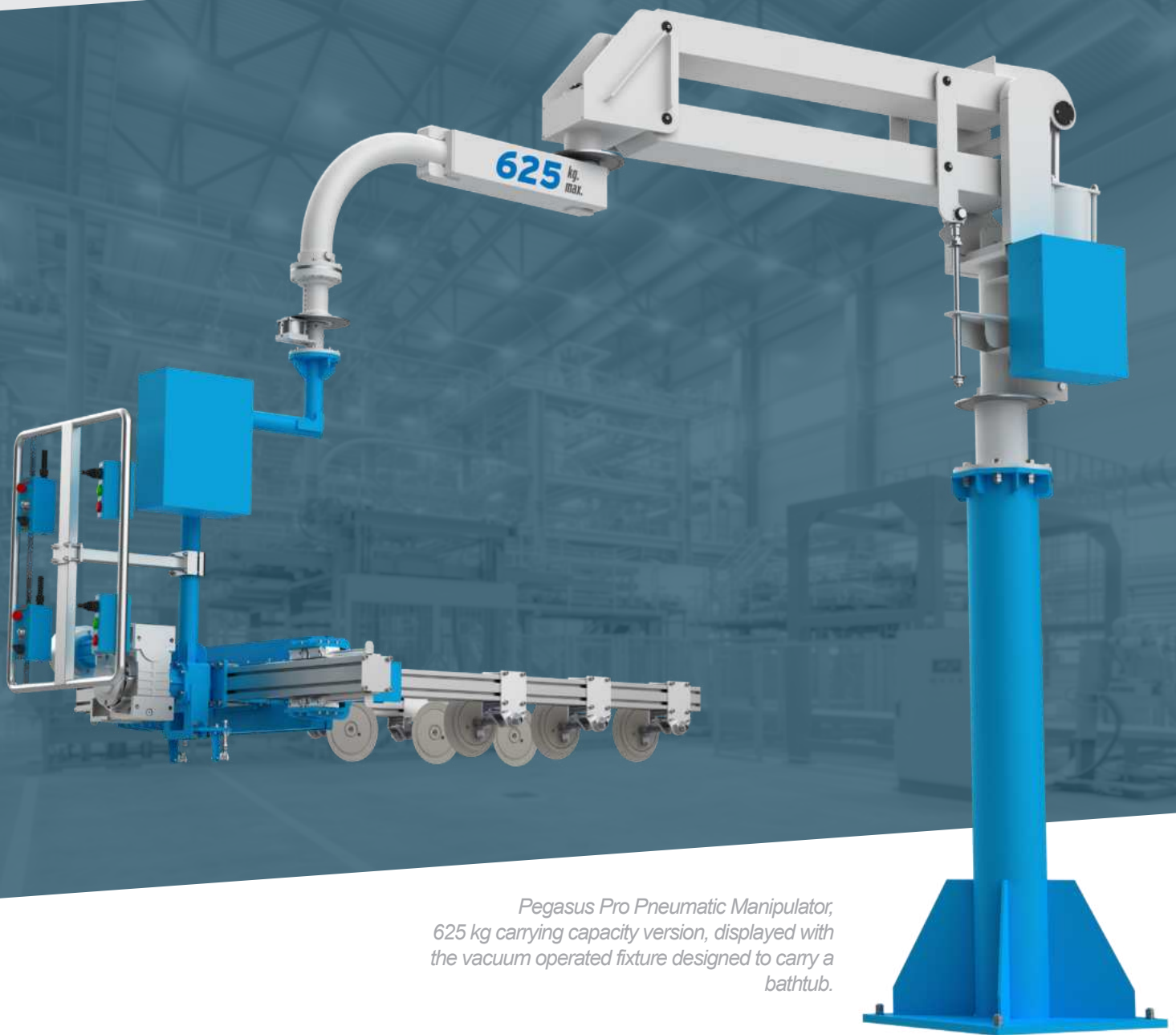

*Pegasus Pro Pneumatic Manipulator,
625 kg carrying capacity version, displayed with
the vacuum operated fixture designed to carry a
bathtub.*

Pegasus Pro Pneumatic Manipulators are designed to move operator-centered loads within the work area with minimum effort. It balances the weight of the load, allowing the operator to carry the load quickly and safely.

Manipulators, either floor mounted or ceiling mounted. Pegasus Pro is equipped with special gripping tools which are particularly suitable to manually handle center offset loads in any direction, in a weightless condition. The manipulator, which consists of two arms, has a total of two brakes on the arm rotation axis. Its versatile structure allows it to fit in any working environment.

Works with dry, filtrated (40 μ m) and oil free compressed air (min. 0.7/0.8 MPa).

625 kg max. weight capacity. 4.500 mm max. radius. 2.450 mm vertical lift.
270 nl/min max. air consumption.

Mounting Options

Pegasus Pro Column Mounted

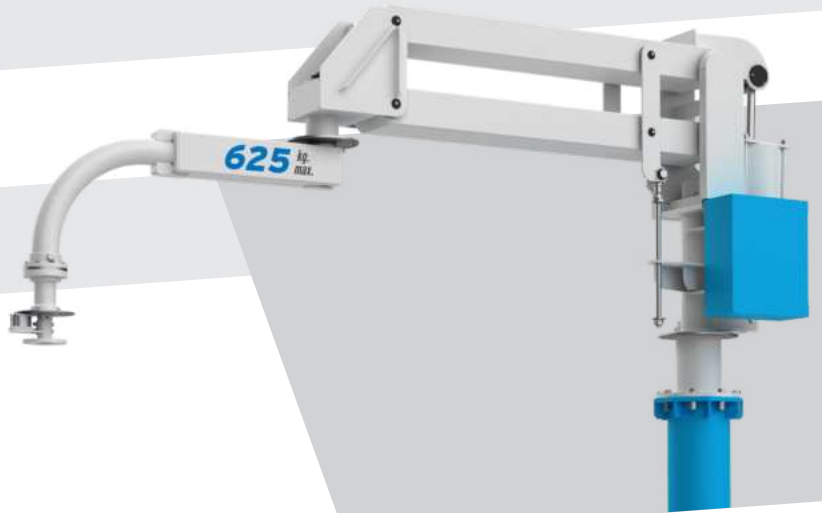

Pegasus Pro Overhead Mounted



Pegasus Pro Overhead Trolley Mounted



Pegasus Pro Technical Details

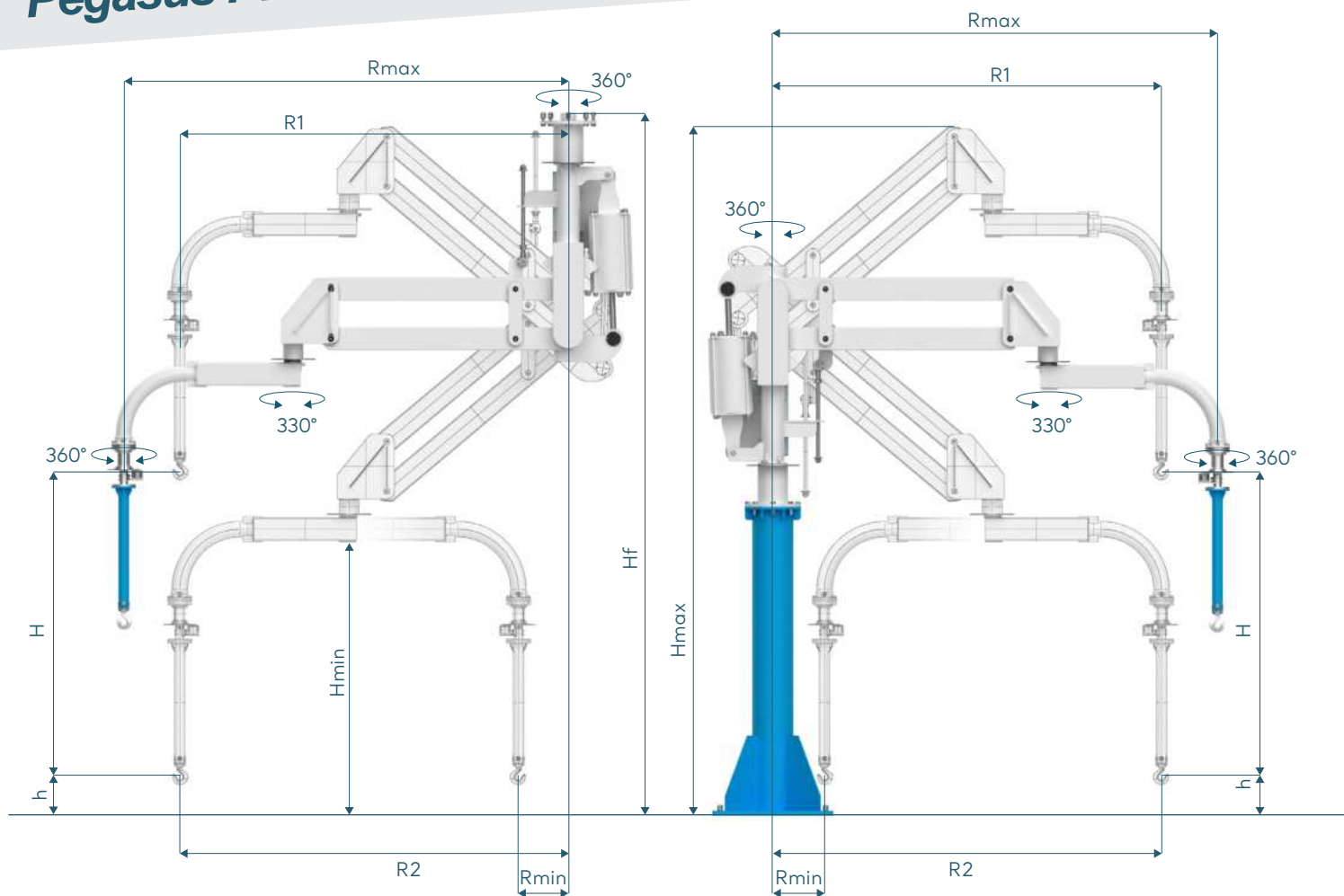

Weight Capacity / kg

		625	475	350	260	185
Max. Radius / mm	Rmax	2500	3000	3500	4000	4500
Min. Radius / mm	Rmin	755	850	1000	1150	1300
Vertical Lift / mm	H	1600	1900	2300	2450	2450
Min. Vertical Lift / mm	*h	200	200	200	200	200
Max. Height / mm	*Hmax	4215	4370	4560	4755	4950
Max. Ceiling Height / mm	*Hf	4200	4900	5000	5100	5100
Min. Height / mm	*Hmin	2000	2000	2000	2000	2000
Radius 1	R1	2195	2635	3060	3485	3915
Radius 2	R2	2195	2635	3060	3485	3915

* Marked dimensions can change according to the customer request.

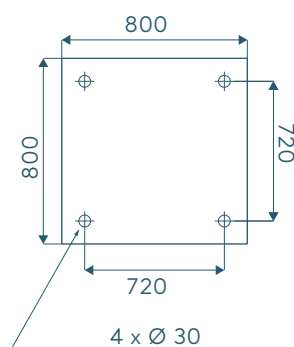

Mounting Plate Dimensions (mm)

Custom Design Fixtures



THEMA Icon

Pneumatic Manipulators with Rigid Arms



Icon Pneumatic Manipulator, 1.000 kg carrying capacity version, displayed with the paper coil fixture.

Icon Pneumatic Manipulators are designed to move operator-centered loads within the work area with minimum effort. It balances the weight of the load, allowing the operator to carry the load quickly and safely.

Manipulators, either floor mounted or ceiling mounted. Icon is equipped with special gripping tools which are particularly suitable to manually handle center offset loads in any direction, in a weightless condition. The manipulator, which consists of two arms, has a total of two brakes on the arm rotation axis. It's versatile structure allows it to fit in any working environment.

Works with dry, filtrated (40 μ m) and oil free compressed air (min. 0.7/0.8 MPa).

1.000 kg max. weight capacity. 4.500 mm max. radius. 2.200 mm vertical lift.
475 nl/min max. air consumption.

Mounting Options

Icon Column Mounted

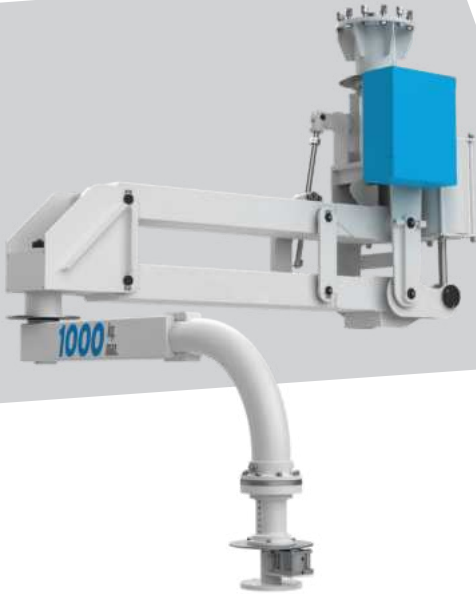
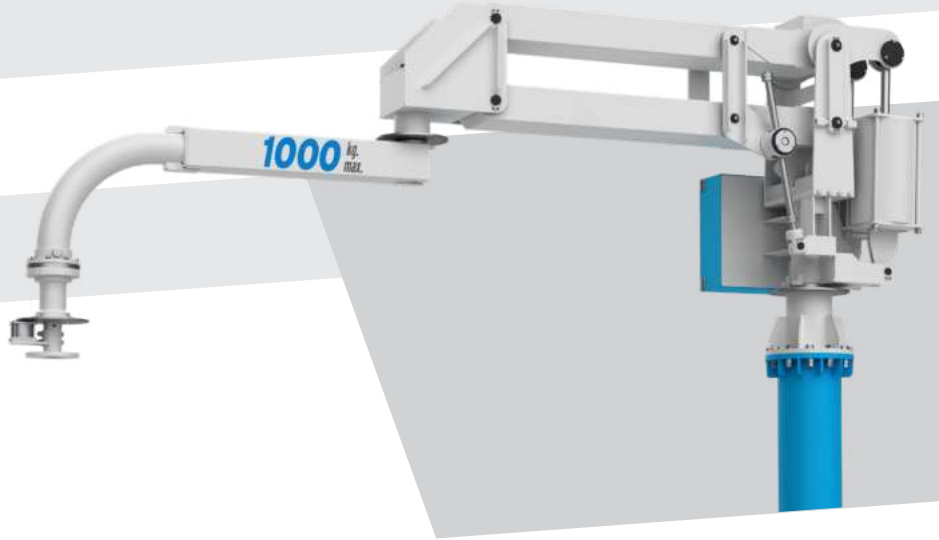

Icon Overhead Mounted

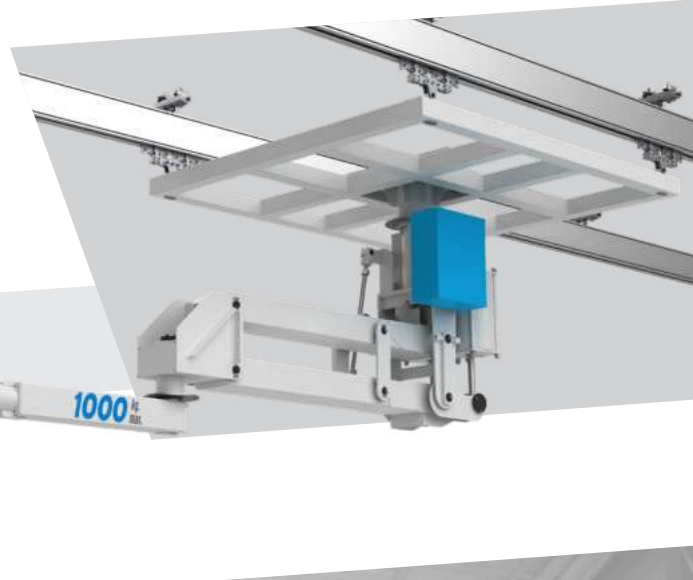

Icon Overhead Trolley Mounted



Icon Technical Details

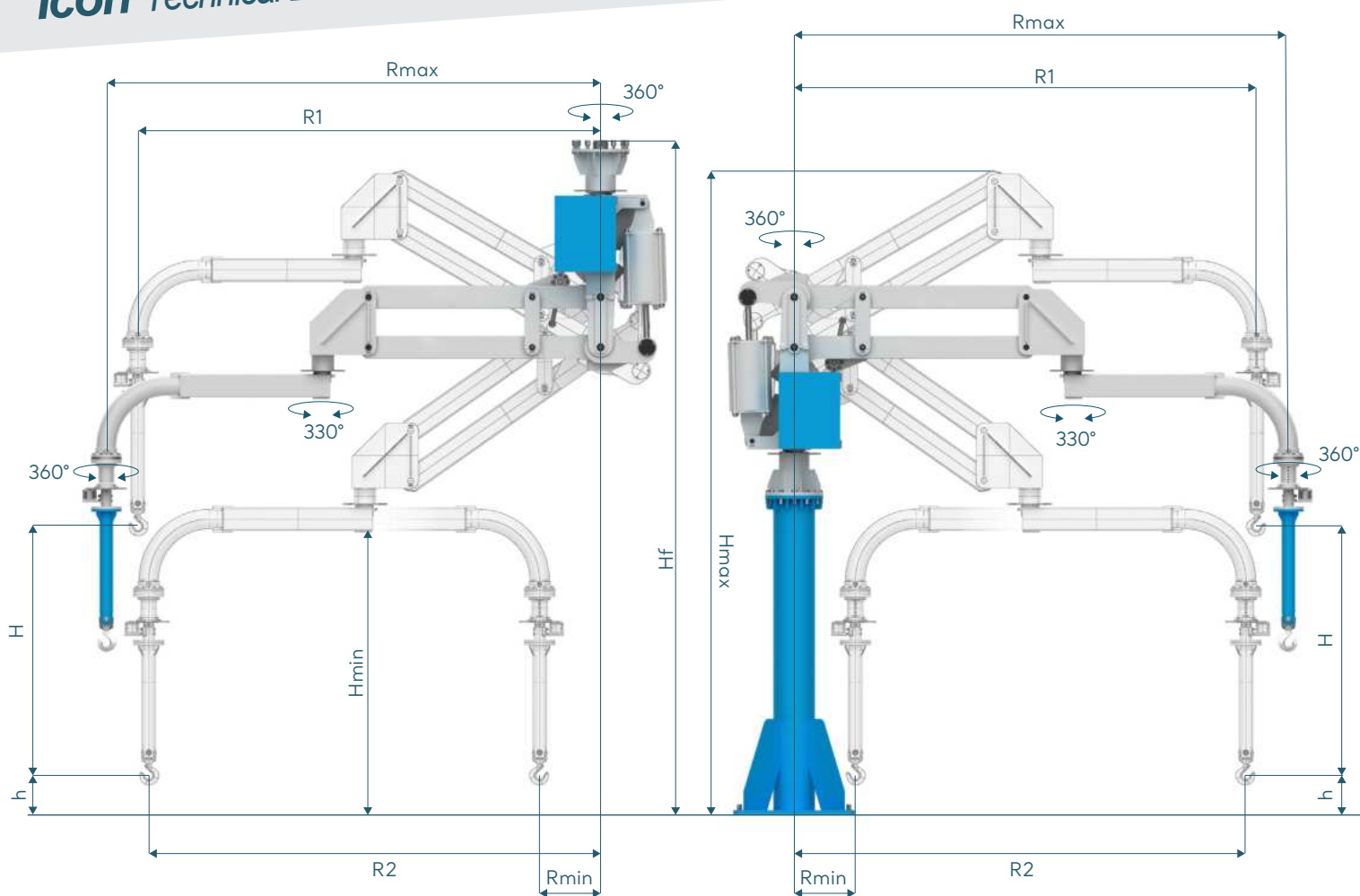

Weight Capacity / kg

		1000	805	625	525	435
Max. Radius / mm	Rmax	2500	3000	3500	4000	4500
Min. Radius / mm	Rmin	832	882	990	1049	1167
Vertical Lift / mm	H	1400	1625	1900	2050	2200
Min. Vertical Lift / mm	*h	200	200	200	200	200
Max. Height / mm	*Hmax	4152	4375	4650	4800	4949
Max. Ceiling Height / mm	*Hf	4300	4415	4545	4616	4690
Min. Height / mm	*Hmin	2000	2000	2000	2000	2000
Radius 1	R1	2302	2771	3232	3711	4190
Radius 2	R2	2254	2715	3166	3640	4114

* Marked dimensions can change according to the customer request.

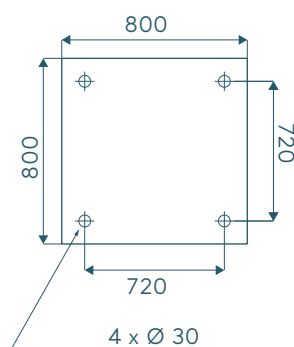

Mounting Plate Dimensions (mm)

THEMA Icon Pro

Pneumatic Manipulators with Rigid Arms



Icon Pro Pneumatic Manipulator, 1.850 kg carrying capacity version, displayed with the gripper for heavy cylinder.

Icon Pro Pneumatic Manipulators are designed to move operator-centered loads within the work area with minimum effort. It balances the weight of the load, allowing the operator to carry the load quickly and safely.

Manipulators, either floor mounted or ceiling mounted. Icon Pro is equipped with special gripping tools which are particularly suitable to manually handle center offset loads in any direction, in a weightless condition. The manipulator, which consists of two arms, has a total of two brakes on the arm rotation axis. It's versatile structure allows it to fit in any working environment.

Works with dry, filtrated (40 µm) and oil free compressed air (min. 0.7/0.8 MPa).

1.850 kg max. weight capacity. 5.000 mm max. radius. 3.000 mm vertical lift.
995 nl/min max. air consumption.

Mounting Options

Icon Pro Column Mounted

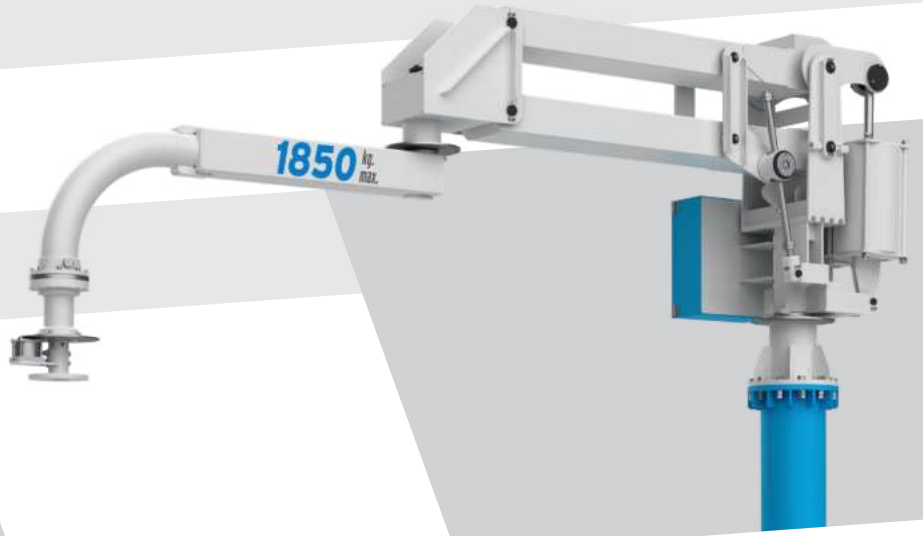

Icon Pro Overhead Mounted



Icon Pro Overhead Trolley Mounted

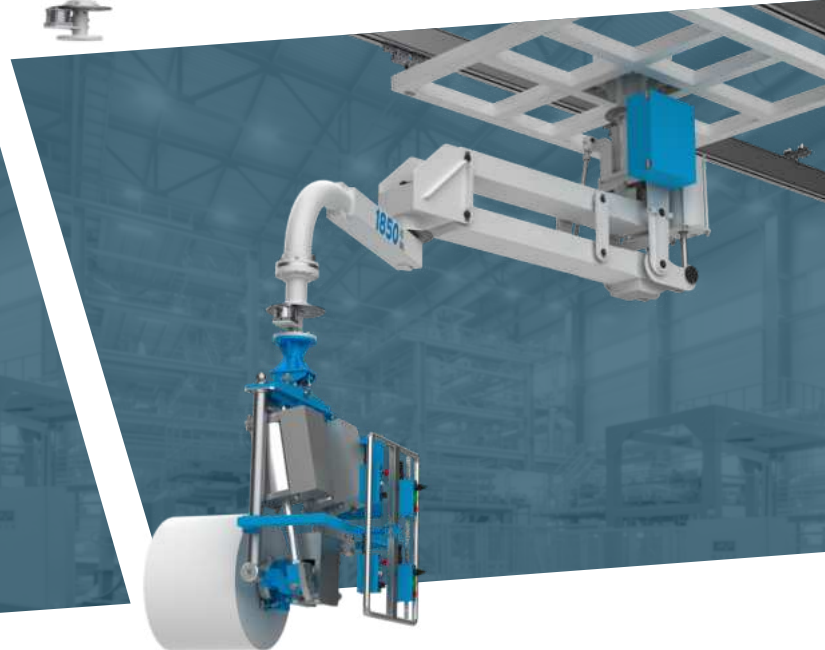
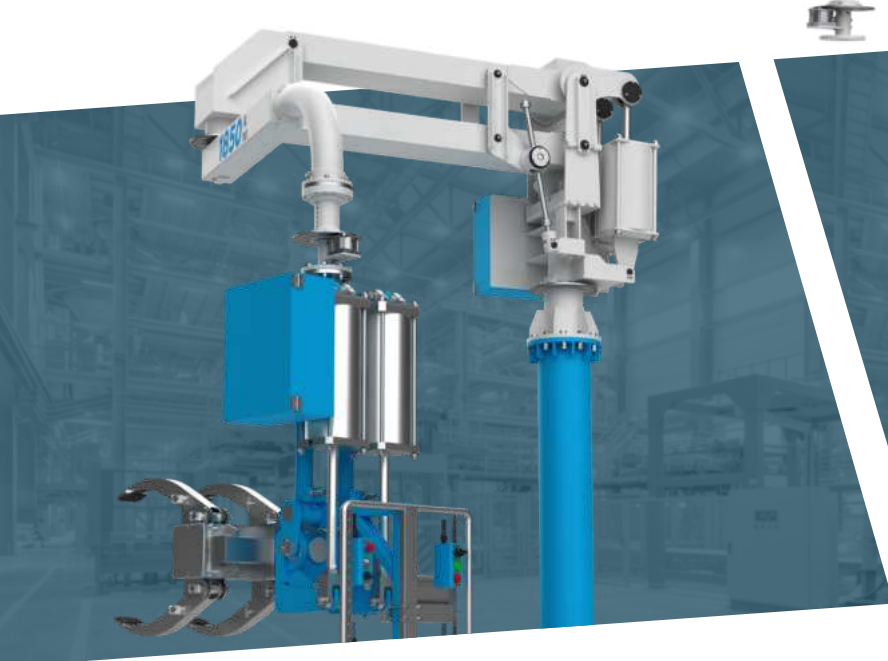
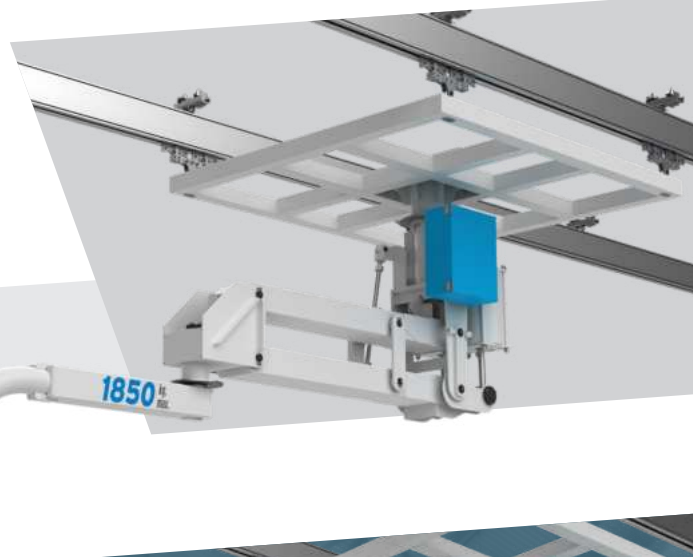

Icon Pro Technical Details

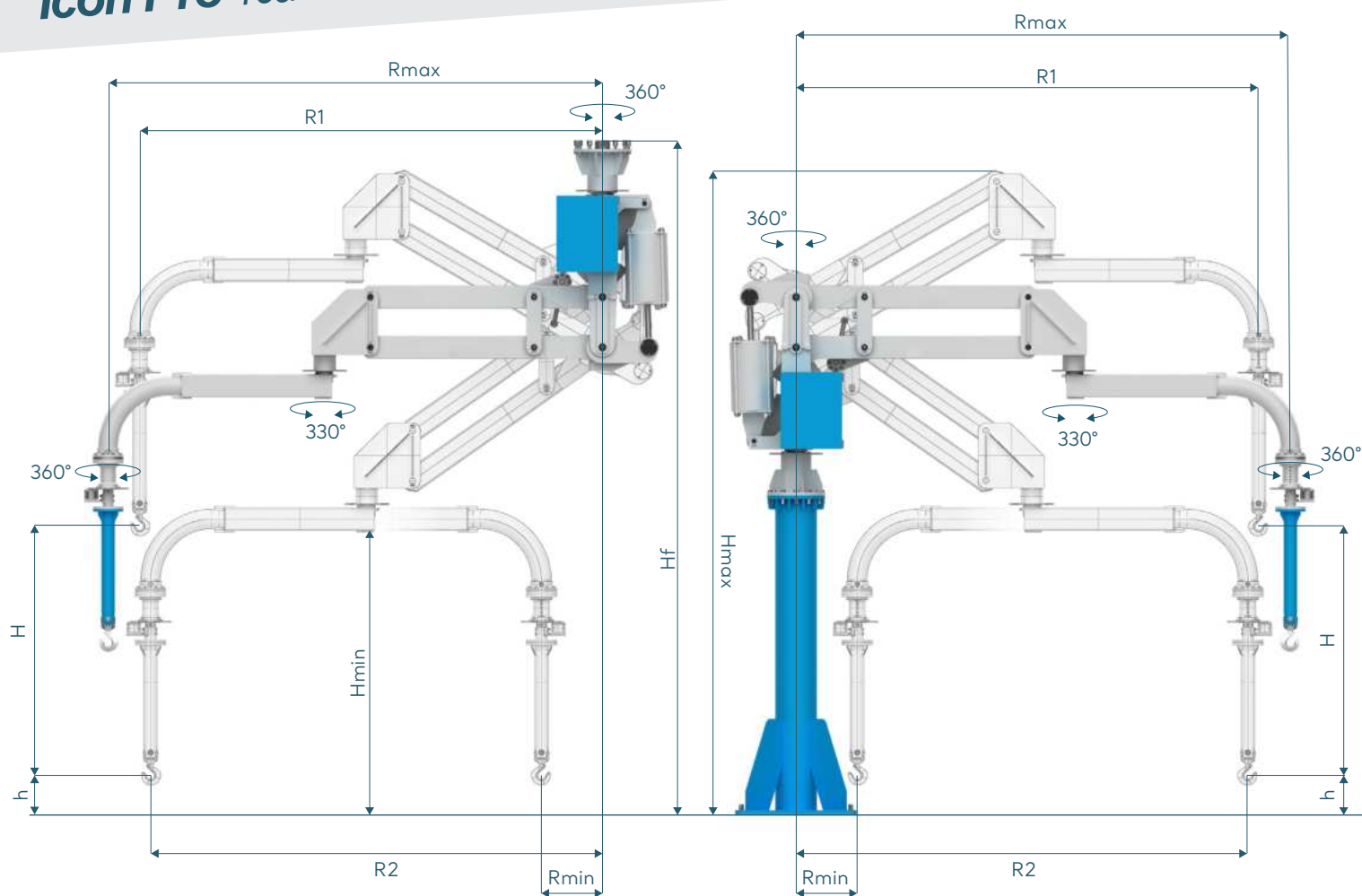

Weight Capacity / kg

		1850	1600	1300	1100	950	780
Max. Radius / mm	Rmax	2500	3000	3500	4000	4500	5000
Min. Radius / mm	Rmin	800	920	1034	1139	1250	1342
Vertical Lift / mm	H	1500	1830	2150	2450	2750	3000
Min. Vertical Lift / mm	*h	200	200	200	200	200	200
Max. Height / mm	*Hmax	4405	4734	5052	5350	5652	5902
Max. Ceiling Height / mm	*Hf	4822	4980	5132	5275	5420	5540
Min. Height / mm	*Hmin	2000	2000	2000	2000	2000	2000
Radius 1	R1	2259	2707	3156	3608	4060	4520
Radius 2	R2	2207	2643	3081	3523	3964	4415

* Marked dimensions can change according to the customer request.

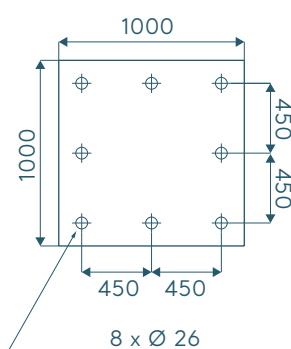

Mounting Plate Dimensions (mm)

Special solutions for special needs!

THEMA Reel Master^{or} Servo & Pneumatic Manipulat

Capacity up to 1.000 kg.

Camera aided loading.

Servo precision with pneumatic system flexibility.

Serving capability up to 60 meters line.

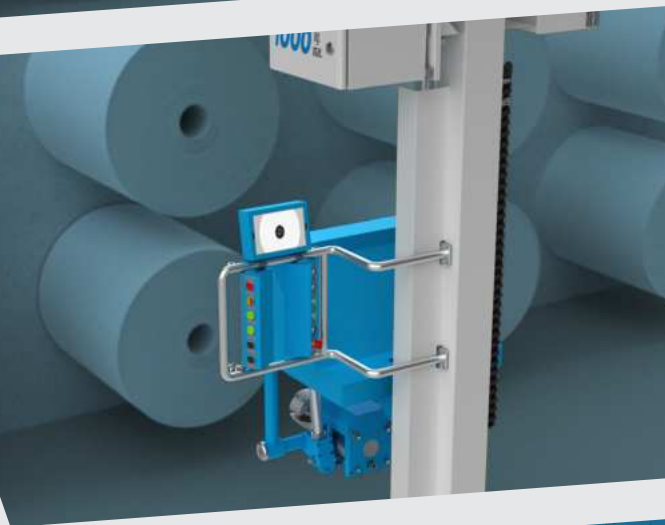

Thema Reel Master is a tailor made solution where servo and pneumatics are used together for loading raw material bobbin's at continuously running lines such as carbon fiber, glass fiber, yarn and acrylic yarn.

It is possible!

*Because we design and produce
just as you need.*

