

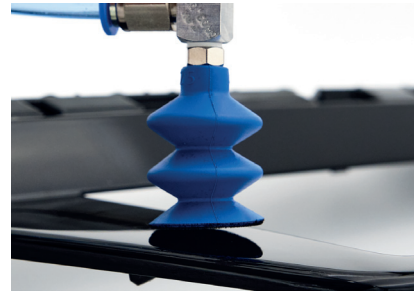

Series | Bellows vacuum cups SB

High-temperature Thermalon®-flocked bellows cups, 2.5 folds – SKT-B2

High-temperature Thermalon®-flocked bellows cups, 2.5 folds – SKT-B2



Product notes

Bellows vacuum cup made of proven Thermalon® with additional patented flock coating of the contact surfaces for the highest demands on non-marking gripping.

Ideally suited for uneven surfaces with special suitability for the removal of hot plastic parts to be painted from the injection molding machine.

Thermalon® is a material mixture with a hardness of 60° Shore A, specially optimized for the plastics industry.

Flock coating made of thin polyamide layer PA6.6 black. Connection by means of plug nipple.

Advantage

- > Nearly non-marking
- > Quick depositing of the product, as there is no static friction due to thin flock coating
- > Free of silicone and other paint-wetting-impairment substances (PWIS)
- > Large suction stroke and good adaptation to curved or uneven product surfaces
- > • Temperature-resistant up to 160 °C (320 °F)

Notes:

The flock coating could cause leakage, which must be taken into account in the layout of the vacuum source.

Technical data

Item no.	Model	 Number of folds	Number of folds	Material / Color	Required suction power for 60 % vacuum [NI/min]	Short-term working temperature < 30 Sec [°C (°F)]
21.009.148.19F	SKT-B2-9	3	2.5	Thermalon®-flocked (bl/sw)	10	0 - 160 (32 - 320)
21.012.149.19F	SKT-B2-12	7	2.5	Thermalon®-flocked (bl/sw)	11	0 - 160 (32 - 320)
21.014.150.19F	SKT-B2-14	10	2.5	Thermalon®-flocked (bl/sw)	16	0 - 160 (32 - 320)
21.020.152.19F	SKT-B2-20	10	2.5	Thermalon®-flocked (bl/sw)	17	0 - 160 (32 - 320)
21.025.153.19F	SKT-B2-25	20	2.5	Thermalon®-flocked (bl/sw)	18	0 - 160 (32 - 320)
21.032.154.19F	SKT-B2-32	14.5	2.5	Thermalon®-flocked (bl/sw)	18	0 - 160 (32 - 320)
21.042.155.19F	SKT-B2-42	22	2.5	Thermalon®-flocked (bl/sw)	21	0 - 160 (32 - 320)

Accessories

Item no.	 Suitable fittings						
	M5-male	M5-female	M6-male	G1/8-male	G1/8-female	G1/4-male	G1/4-female
21.009.148.19F	270.772	270.347	270.104	270.033	270.478	--	--
21.012.149.19F	270.772	270.347	270.104	270.033	270.478	--	--
21.014.150.19F	270.772	270.347	270.104	270.033	270.478	--	--
21.020.152.19F	270.772	270.347	270.104	270.033	270.478	--	--
21.025.153.19F	270.772	270.347	270.104	270.033	270.478	--	--
21.032.154.19F	--	--	270.315	270.196	270.114	270.190	270.192
21.042.155.19F	--	--	270.315	270.196	270.114	270.190	270.192



Dimensions

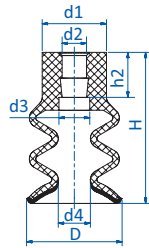

Drawing A

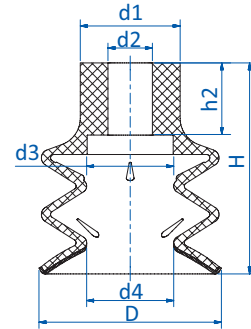

Drawing B

Item no.	Drawing	Ø D [mm]	Ø d1 [mm]	Ø d2 [mm]	Ø d3 [mm]	Ø d4 [mm]	H [mm]	h2 [mm]
21.009.148.19F	A	10.1	9	3.8	--	3.9	15.5	7
21.012.149.19F	A	12.9	10	3.8	4.8	5	21.5	7
21.014.150.19F	A	14.9	10	3.8	4.8	5	23.5	7
21.020.152.19F	A	20.9	10	3.8	4.8	10	23.5	7
21.025.153.19F	A	25.9	10	3.8	4.8	10.1	34.5	7
21.032.154.19F	B	32.9	18	8	15.7	15.7	38	13
21.042.155.19F	B	42.9	18	8	15	18	46.5	13