



# Series | Flat vacuum cups SF

Vacuum suction plates with foam rubber sealing lip – SP-PLM

## Vacuum suction plates with foam rubber sealing lip – SP-PLM



### Product description

Flat vacuum suction plate with a soft, foamed sealing lip made of EPDM. The sealing lip snaps (form-locking) into a support plate.

### Advantage

- > Good sealing of heavily textured surfaces
- > Cost-effective replacement of worn seals

### Technical data

Item no.	Model / Lip dimensions	Connection thread		Weight [g]	Material / Colour
160.042.001._*	SP-PLM-35	G1/8-female	1	22	EPDM (sw)
160.067.003._*	SP-PLM-60	G1/8-female	1	63	EPDM (sw)
160.107.006._*	SP-PLM-100	G1/2-female	1	234	EPDM (sw)
160.145.014._*	SP-PLM-140	G1/2-female	1	588	EPDM (sw)
160.215.009._*	SP-PLM-200	G3/4-female	2.5	1,220	EPDM (sw)
160.315.012._*	SP-PLM-300	G3/4-female	2.5	2,482	EPDM (sw)

### Accessories

Spare vacuum cup:	Touch valve:
102.038.451.15	270.129
102.060.452.15	270.129
102.100.453.15	270.130
102.140.454.15	270.130
102.210.455.15	--
102.310.456.15	--

### Dimensions

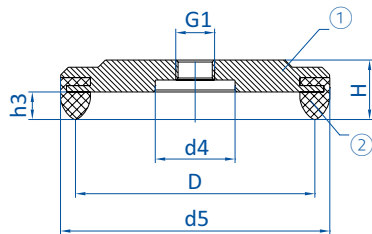

Drawing A

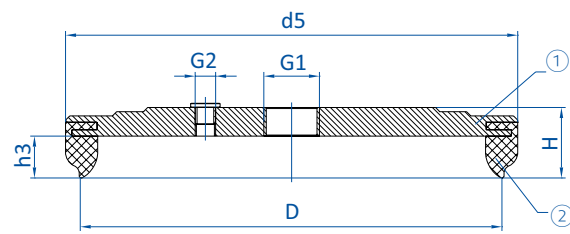

Drawing B

① = Aluminum ② = EPDM foamed

Item no.	Drawing	Ø D [mm]	Ø d4 [mm]	Ø d5 [mm]	G1	G2	H [mm]	h3 [mm]
160.042.001._*	A	35	20	43	G1/8	--	15	7
160.067.003._*	A	60	20	68	G1/8	--	15	7
160.107.006._*	A	100	30	108	G1/2	--	19	7
160.145.014._*	A	138	30	145	G1/2	--	24	7
160.215.009._*	B	201	--	215	G3/4	G1/8	34	20
160.315.012._*	B	300	--	315	G3/4	G1/8	34	20

\* When ordering please add the appropriate material code to item no. You will find it on [www.fipa.com](http://www.fipa.com).