



Vacuum gripping systems | Area gripper FSG

Area gripper with sealing foam

Area gripper with sealing foam



Product notes

- > For automated handling of individual products or product layers without changing grippers
- > Low noise emissions for a pleasant working environment
- > With built-in ejectors or with connection to a central vacuum supply
- > With check valves or flow reduction
- > The sealing foam can be replaced quickly, non-destructively and without residues
- > Area grippers with check valves are suitable for swivel/tilt movements up to less than 90°
- > Equipped with vacuum gauge 91.005 as standard
- > Other sealing foams (height, shape) on request

Technical data

Item no.	Valve type	Vacuum generation	Number of suction cells	Working pressure [bar (psi)]	Air consumption at 6 bar (87 psi) [l/min]	Suction power at 6 bar (87 psi) [Nl/min]	Nominal flow rate [Nl/min]	Suction force at nominal power [N]	Vacuum level [mbar (inHg)]	Weight [kg]	Dimensions		
											A [mm]	Ø G [mm]	H [mm]
FSG.VG130.295.5F20C2	Check valve	with integrated ejectors	53	4 - 6 (58 - 87)	200	700	--	426	-550 (-16.2)	2.6	295	--	--
FSG.VG130.434.5F20C2	Check valve	with integrated ejectors	83	4 - 6 (58 - 87)	200	700	--	688	-550 (-16.2)	3.3	434	--	--
FSG.VG130.572.5F20C3	Check valve	with integrated ejectors	113	4 - 6 (58 - 87)	300	1,050	--	909	-550 (-16.2)	3.8	572	--	--
FSG.VG130.711.5F20C4	Check valve	with integrated ejectors	143	4 - 6 (58 - 87)	400	1,400	--	1,150	-550 (-16.2)	4.5	711	--	--
FSG.VG130.849.5F20C4	Check valve	with integrated ejectors	173	4 - 6 (58 - 87)	400	1,400	--	1,391	-550 (-16.2)	5.2	849	--	--
FSG.VG130.988.5F20C5	Check valve	with integrated ejectors	203	4 - 6 (58 - 87)	500	1,750	--	1,633	-550 (-16.2)	5.6	988	--	--
FSG.VG130.1126.5F20C6	Check valve	with integrated ejectors	233	4 - 6 (58 - 87)	600	2,100	--	1,874	-550 (-16.2)	7	1,126	--	--
FSG.VG130.1265.5F20C6	Check valve	with integrated ejectors	263	4 - 6 (58 - 87)	600	2,100	--	2,115	-550 (-16.2)	7.4	1,265	--	--
FSG.PG130.295.5F20C2	Flow reduction	with integrated ejectors	53	4 - 6 (58 - 87)	200	700	--	426	-550 (-16.2)	2.6	295	--	--
FSG.PG130.434.5F20C2	Flow reduction	with integrated ejectors	83	4 - 6 (58 - 87)	200	700	--	688	-550 (-16.2)	3.3	434	--	--
FSG.PG130.572.5F20C3	Flow reduction	with integrated ejectors	113	4 - 6 (58 - 87)	300	1,050	--	909	-550 (-16.2)	3.8	572	--	--
FSG.PG130.711.5F20C4	Flow reduction	with integrated ejectors	143	4 - 6 (58 - 87)	400	1,400	--	1,150	-550 (-16.2)	4.5	711	--	--
FSG.PG130.849.5F20C4	Flow reduction	with integrated ejectors	173	4 - 6 (58 - 87)	400	1,400	--	1,391	-550 (-16.2)	5.2	849	--	--
FSG.PG130.988.5F20C5	Flow reduction	with integrated ejectors	203	4 - 6 (58 - 87)	500	1,750	--	1,633	-550 (-16.2)	5.6	988	--	--



Technical data											Dimensions		
Item no.	Valve type	Vacuum generation	Number of suction cells	Working pressure [bar (psi)]	Air consumption at 6 bar (87 psi) [l/min]	Suction power at 6 bar (87 psi) [W/min]	Nominal flow rate [l/min]	Suction force at nominal power [N]	Vacuum level [mbar (inHG)]	Weight [kg]	A [mm]	Ø G [mm]	H [mm]
FSG.PG130.1126.5F20C6	Flow reduction	with integrated ejectors	233	4 - 6 (58 - 87)	600	2,100	--	1,874	-550 (-16.2)	7	1,126	--	--
FSG.PG130.1265.5F20C6	Flow reduction	with integrated ejectors	263	4 - 6 (58 - 87)	600	2,100	--	2,115	-550 (-16.2)	7.4	1,265	--	--
FSG.VG130.295.5F20T	Check valve	central vacuum supply	53	4 - 6 (58 - 87)	--	--	150	320	-300 (-8.9)	2.3	295	32.5	54
FSG.VG130.434.5F20T	Check valve	central vacuum supply	83	4 - 6 (58 - 87)	--	--	300	501	-300 (-8.9)	3	434	32.5	54
FSG.VG130.572.5F20T	Check valve	central vacuum supply	113	4 - 6 (58 - 87)	--	--	400	682	-300 (-8.9)	3.5	572	32.5	54
FSG.VG130.711.5F20T	Check valve	central vacuum supply	143	4 - 6 (58 - 87)	--	--	510	863	-300 (-8.9)	4.2	711	60	49
FSG.VG130.849.5F20T	Check valve	central vacuum supply	173	4 - 6 (58 - 87)	--	--	600	1,044	-300 (-8.9)	4.9	849	60	49
FSG.VG130.988.5F20T	Check valve	central vacuum supply	203	4 - 6 (58 - 87)	--	--	750	1,224	-300 (-8.9)	5.1	988	60	49
FSG.VG130.1126.5F20T	Check valve	central vacuum supply	233	4 - 6 (58 - 87)	--	--	850	1,405	-300 (-8.9)	6.6	1,126	60	49
FSG.VG130.1265.5F20T	Check valve	central vacuum supply	263	4 - 6 (58 - 87)	--	--	950	1,586	-300 (-8.9)	7	1,265	60	49
FSG.PG130.295.5F20T	Flow reduction	central vacuum supply	53	4 - 6 (58 - 87)	--	--	150	320	-300 (-8.9)	2.3	295	32.5	54
FSG.PG130.434.5F20T	Flow reduction	central vacuum supply	83	4 - 6 (58 - 87)	--	--	300	501	-300 (-8.9)	3	434	32.5	54
FSG.PG130.572.5F20T	Flow reduction	central vacuum supply	113	4 - 6 (58 - 87)	--	--	400	682	-300 (-8.9)	3.5	572	32.5	54
FSG.PG130.711.5F20T	Flow reduction	central vacuum supply	143	4 - 6 (58 - 87)	--	--	510	863	-300 (-8.9)	4.2	711	60	49
FSG.PG130.849.5F20T	Flow reduction	central vacuum supply	173	4 - 6 (58 - 87)	--	--	600	1,044	-300 (-8.9)	4.9	849	60	49
FSG.PG130.988.5F20T	Flow reduction	central vacuum supply	203	4 - 6 (58 - 87)	--	--	750	1,224	-300 (-8.9)	5.1	988	60	49
FSG.PG130.1126.5F20T	Flow reduction	central vacuum supply	233	4 - 6 (58 - 87)	--	--	850	1,405	-300 (-8.9)	6.6	1,126	60	49
FSG.PG130.1265.5F20T	Flow reduction	central vacuum supply	263	4 - 6 (58 - 87)	--	--	950	1,586	-300 (-8.9)	7	1,265	60	49



Vacuum gripping systems | Area gripper FSG

Area gripper with sealing foam

Optional accessories and spare parts

Optional accessories:

- > Electronic vacuum switch with display GS02.001
- > Electronic vacuum switch GS02.003
- > Electronic vacuum and pressure switch 20.026
- > Flange module for area gripper FSG.ACC130.0001
- > Slot nut 1x M8 for area gripper FSG.ACC130.0002
- > Optical sensor with sensor holder FSG.ACC130.0004

Spare parts:

- > Spare foam length 295 mm FSG.ACC130.295.5F20
- > Spare foam length 434 mm FSG.ACC130.434.5F20
- > Spare foam length 572 mm FSG.ACC130.572.5F20
- > Spare foam length 711 mm FSG.ACC130.711.5F20
- > Spare foam length 849 mm FSG.ACC130.849.5F20
- > Spare foam length 988 mm FSG.ACC130.988.5F20
- > Spare foam length 1126 mm FSG.ACC130.1126.5F20
- > Spare foam length 1265 mm FSG.ACC130.1265.5F20
- > Ejector for area gripper FSG.ACC130.0003

Dimensions

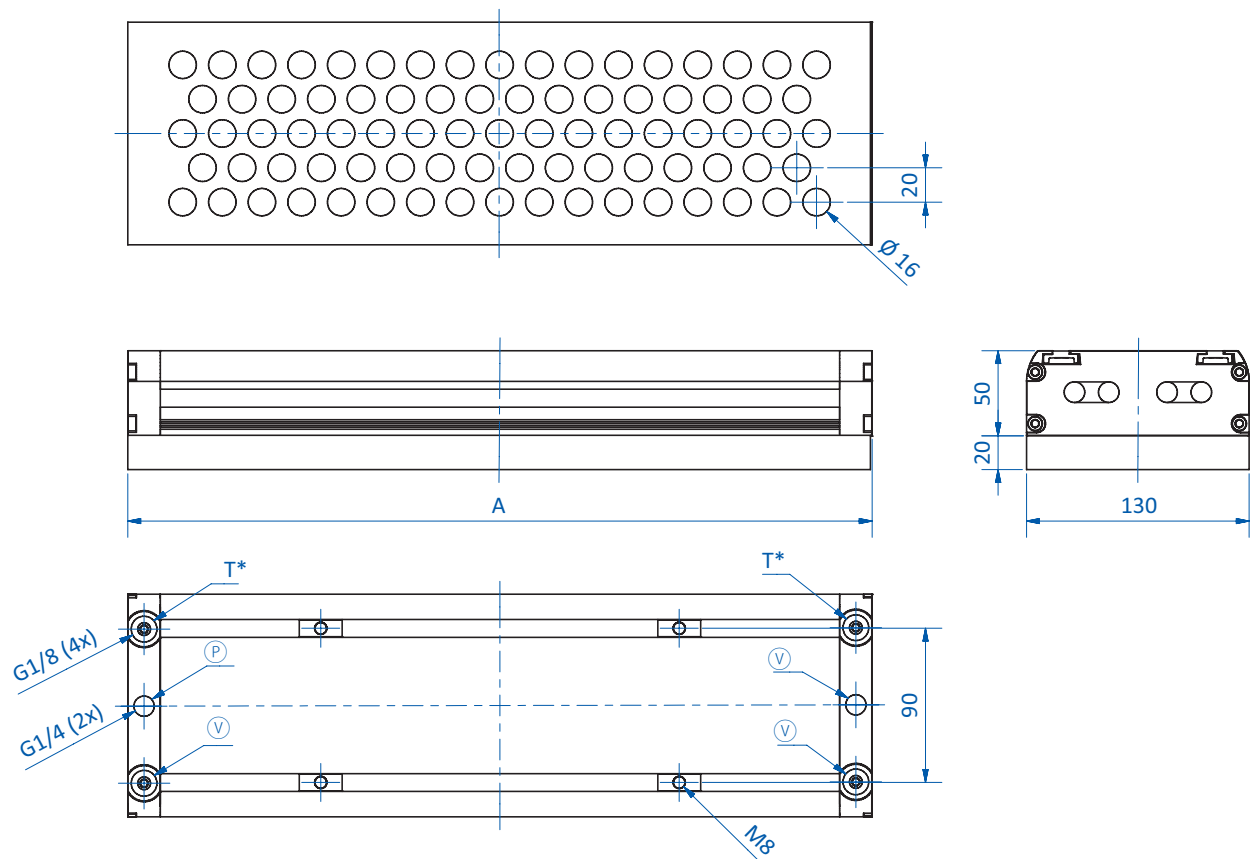

Vacuum generation with integrated ejectors

Ⓟ = Compressed air connection Ⓥ = Vacuum connection * = Transfer line



Dimensions

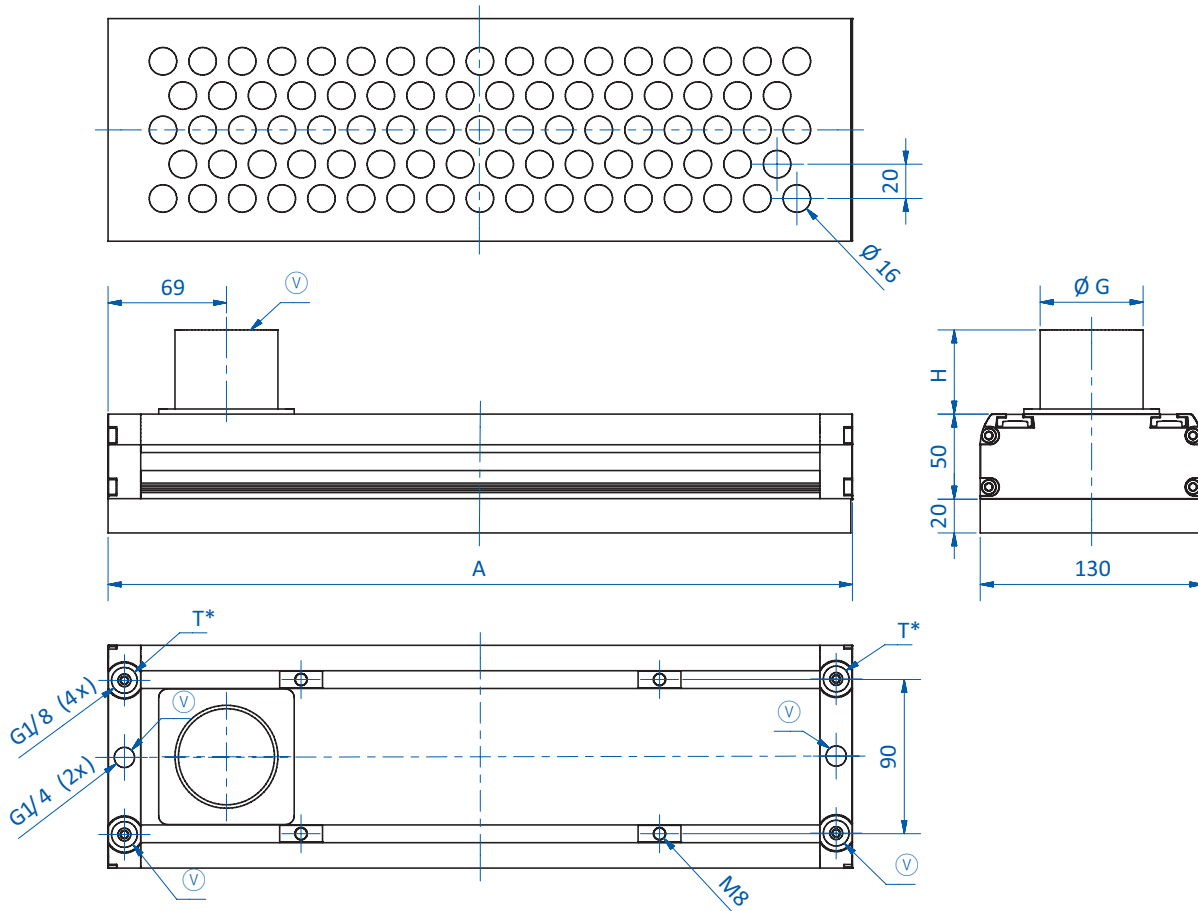

Vacuum generation via central vacuum supply

Ⓟ = Compressed air connection Ⓟ = Vacuum connection * = Transfer line