







### Flat vacuum cups with fully assembled fitting – SP-F

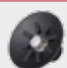

Product description	Advantage
<p>Universal flat vacuum cups in even or supported design. Series with sensing valve prevents dropping of the product if individual vacuum cups in a system are not in contact with the product.</p> <p>Version: Complete with vacuum cup fitting and filter screen.</p>	<ul style="list-style-type: none"> <li>&gt; High suction force</li> <li>&gt; Fast cycle times possible</li> <li>&gt; Very resistant to wear (Tepuflex®)</li> <li>&gt; Compatible with established products from other vendors</li> </ul>

Technical data						Accessories
Item no.	Model / Lip dimensions	Connection thread		Material / Colour	Spare vacuum cup:	
	<b>Smooth design with fitting &amp; filter screen</b>					
<b>120.020.006._*</b>	SP-F-20	G1/8-male, M5-female	2.5	SI (tr), CR (sw)	102.020.095._*	
<b>120.030.013._*</b>	SP-F-30	G1/8-male, M5-female	3.5	SI (tr), CR (sw)	102.030.096._*	
<b>120.040.076._*</b>	SP-F-40	G1/8-female	4	SI (tr), CR (sw)	102.040.094._*	
<b>120.050.078._*</b>	SP-F-50	G1/8-female	6.5	SI (tr), CR (sw)	102.050.097._*	
	<b>Smooth design with fitting, filter screen &amp; touch valve</b>					
<b>121.030.006._*</b>	SP-F-30	G1/8-male, M5-female	2.5	SI (tr), CR (sw)	102.030.096._*	
<b>121.040.007._*</b>	SP-F-40	G1/8-female	4	SI (tr), CR (sw)	102.040.094._*	
<b>121.050.008._*</b>	SP-F-50	G1/8-female	2.5	SI (tr), CR (sw)	102.050.097._*	
	<b>With cleats, fitting &amp; filter screen</b>					
<b>123.020.003._*</b>	SP-FA-20	G1/8-male, M5-female	1	Tepuflex® (or), SI (tr), CR (sw)	125.020.004._*	
<b>123.025.010._*</b>	SP-FA-25	G1/8-male, M5-female	1	Tepuflex® (or), SI (tr), CR (sw)	125.025.007._*	
<b>123.030.019._*</b>	SP-FA-30	G1/8-male, M5-female	2	Tepuflex® (or), SI (tr), CR (sw)	125.030.010._*	
<b>123.040.028._*</b>	SP-FA-40	G1/8-female	2	Tepuflex® (or), SI (tr), CR (sw)	125.040.013._*	
<b>123.050.034._*</b>	SP-FA-50	G1/8-female	2.5	Tepuflex® (or), SI (tr), CR (sw)	125.050.017._*	
<b>152.078.133._*</b>	SP-FA-75	G1/8-female	3	Tepuflex® (or), SI (tr), CR (sw)	154.078.027._*	
<b>152.078.136._*</b>	SP-FA-75	G3/8-female	3	Tepuflex® (or), SI (tr), CR (sw)	154.078.027._*	
<b>152.078.139._*</b>	SP-FA-75	G1/2-female	3	Tepuflex® (or), SI (tr), CR (sw)	154.078.027._*	
<b>152.113.134._*</b>	SP-FA-110	G3/8-female	5	Tepuflex® (or), SI (tr), CR (sw)	154.113.028._*	
<b>152.113.137._*</b>	SP-FA-110	G1/2-female	5	Tepuflex® (or), SI (tr), CR (sw)	154.113.028._*	
<b>152.155.135._*</b>	SP-FA-150	G1/2-female	5	Tepuflex® (or), SI (tr), CR (sw)	154.155.026._*	
<b>152.155.138._*</b>	SP-FA-150	G3/4-female	5	Tepuflex® (or), SI (tr), CR (sw)	154.155.026._*	
	<b>With cleats, fitting, filter screen &amp; touch valve</b>					
<b>124.030.002._*</b>	SP-FA-30	G1/8-male, M5-female	2	SI (tr), CR (sw)	125.030.010._*	
<b>124.040.006._*</b>	SP-FA-40	G1/8-female	2	SI (tr), CR (sw)	125.040.013._*	
<b>124.050.009._*</b>	SP-FA-50	G1/8-female	2.5	SI (tr), CR (sw)	125.050.017._*	

\* When ordering please add the appropriate material code to item no. You will find it on [www.fipa.com](http://www.fipa.com).



# Series | Flat vacuum cups SF

Flat vacuum cups with fully assembled fitting – SP-F

## Flat vacuum cups with fully mounted fitting

Example:

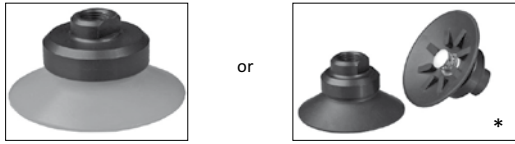

\* Version with touch valve available only for flat vacuum cups in smooth design and flat vacuum cups with cleats

- > High process reliability thanks to permanently installed fitting
- > Worn sealing lips can be replaced if necessary

## Dimensions

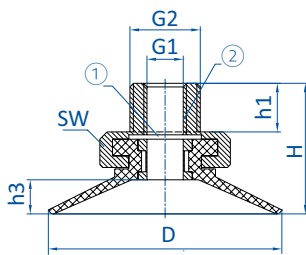

Drawing A

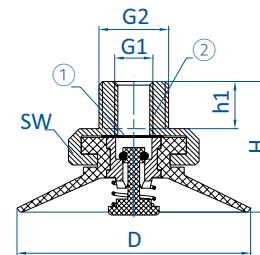

Drawing B

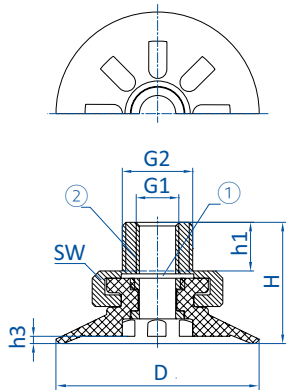

Drawing C

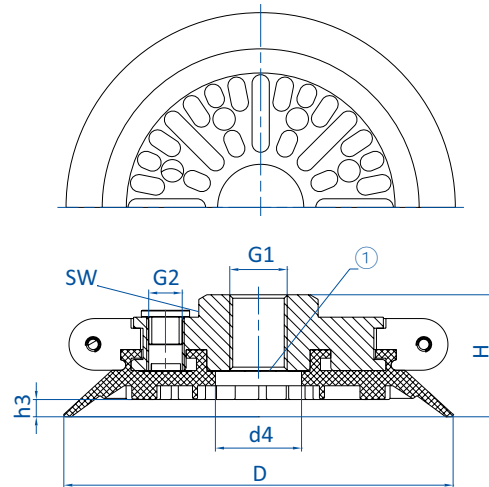

Drawing D

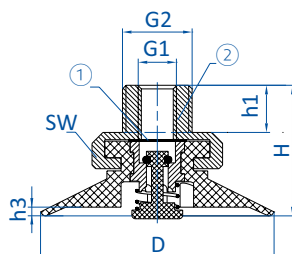

Drawing E

① = Filter screen ② = Aluminum

\* When ordering please add the appropriate material code to item no. You will find it on [www.fipa.com](http://www.fipa.com).

# Series | Flat vacuum cups SF

Flat vacuum cups with fully assembled fitting – SP-F



Item no.	Drawing	Ø D [mm]	Ø d4 [mm]	G1	G2	H [mm]	h1 [mm]	h3 [mm]	SW
<b>Smooth design with fitting &amp; filter screen</b>									
120.020.006.*	A	22	--	M5	G1/8	15.5	6.5	3	17
120.030.013.*	A	32	--	M5	G1/8	18	6.5	4.5	17
120.040.076.*	A	42	--	G1/8	--	22	--	6	12
120.050.078.*	A	52	--	G1/8	--	27	--	8.5	12
<b>Smooth design with fitting, filter screen &amp; touch valve</b>									
121.030.006.*	B	32	--	M5	G1/8	18	6.5	--	17
121.040.007.*	B	42	--	G1/8	--	22	--	--	12
121.050.008.*	B	52	--	G1/8	--	27	--	--	12
<b>With cleats, fitting &amp; filter screen</b>									
123.020.003.*	C	22	--	M5	G1/8	15.5	6.5	0.9	17
123.025.010.*	C	28	--	M5	G1/8	16.5	6.5	1	17
123.030.019.*	C	32	--	M5	G1/8	18	6.5	1.2	17
123.040.028.*	C	42	--	G1/8	--	22	--	2.1	12
123.050.034.*	C	53	--	G1/8	--	26	--	2	12
152.078.133.*	D	78	10	G1/8	--	26	--	3	28
152.078.136.*	D	78	10	G3/8	--	26	--	3	28
152.078.139.*	D	78	10	G1/2	--	26	--	3	28
152.113.134.*	D	113	25	G3/8	G1/8	35	--	5	30
152.113.137.*	D	113	25	G1/2	G1/8	35	--	5	30
152.155.135.*	D	155	25	G1/2	G1/8	38	--	5	38
152.155.138.*	D	155	25	G3/4	G1/8	38	--	5	38
<b>With cleats, fitting, filter screen &amp; touch valve</b>									
124.030.002.*	E	32	--	M5	G1/8	18	--	1.2	17
124.040.006.*	E	42	--	G1/8	--	22	--	2.1	12
124.050.009.*	E	53	--	G1/8	--	26	--	2	12

\* When ordering please add the appropriate material code to item no. You will find it on [www.fipa.com](http://www.fipa.com).